

This document should not be relied on or used in circumstances other than those for which it was originally prepared and for which BERGSTROM ARCHITECTS was commissioned. BERGSTROM ARCHITECTS accepts no responsibility for this document to any other party other than the person by whom it was commissioned.

PROJECT ADDRESS  
34 INGLIS STREET  
MUDGEE, NSW, 2850

1:150@A1  
1:300@A3

17/02/2025 10:11:47 AM

- GENERAL NOTES:**
- DO NOT SCALE OFF DRAWINGS. USE ONLY FIGURED DIMENSIONS.
  - ALL DIMENSIONS ARE TO BE VERIFIED ON SITE PRIOR TO COMMENCEMENT OF ANY WORK.
  - ANY DISCREPANCIES ARE TO BE BROUGHT TO THE ATTENTION OF BERGSTROM ARCHITECTS PTY LTD BEFORE COMMENCEMENT OF ANY WORK.
  - ALL DIMENSIONS ARE GIVEN IN MILLIMETRES EXCEPT LEVELS & DRAWINGS TO SCALE 1:500 AND SMALLER WHICH ARE IN METRES.
  - THIS DRAWING IS TO BE READ IN CONJUNCTION WITH RELEVANT CONSULTANTS DOCUMENTATION.
  - ALL DESIGNS, PRINTS & SPECIFICATIONS ARE THE PROPERTY OF BERGSTROM ARCHITECTS PTY LTD & MUST NOT BE ISSUED, USED OR REPRODUCED WITHOUT WRITTEN PERMISSION FROM BERGSTROM ARCHITECTS PTY LTD.
- DA NOTES:**
- DRAWINGS ARE TO BE READ IN CONJUNCTION WITH THE DEVELOPMENT APPLICATION FORM AND STATEMENT OF ENVIRONMENTAL EFFECTS.
  - THE NEW BUILDING WORK IS TO BE CARRIED OUT IN ACCORDANCE WITH THE PROVISIONS OF THE BCA.
  - ALL NEW BUILDING WORK IS TO BE CARRIED OUT IN ACCORDANCE WITH THE NOTICE OF DETERMINATION FOR THIS DEVELOPMENT APPLICATION.
  - DISABILITY ACCESS AND FACILITIES TO BE IN ACCORDANCE WITH AS 1428.1 AND AS 1428.4
  - THE PROPOSED WORKS WILL ADDRESS FIRE SAFETY MEASURES TO COMPLY WITH THE PERFORMANCE REQUIREMENTS OF THE BCA (EITHER DEEMED TO SATISFY OR ALTERNATIVE SOLUTIONS TO BE PREPARED BY A QUALIFIED FIRE ENGINEER).
  - ALL MEANS OF EGRESS, EMERGENCY LIGHTING, EXIT SIGNS, FIRE DOORS, FIRE HYDRANT SYSTEMS, FIRE HOSE REEL SYSTEMS, PORTABLE FIRE EXTINGUISHERS, SMOKE AND HEAT VENTS, SMOKE DETECTION, ALARM AND EXHAUST SYSTEM TO BE IN ACCORDANCE WITH THE BCA AND OTHER RELEVANT AUSTRALIAN STANDARDS.

REVISIONS			
B	17/02/2025	S4.55 ISSUE	
A	13/09/2023	DA ISSUE	



CLIENT IMG GROUP		PROJECT 22-017 FEDERAL HOTEL	SCALE 1:150@A1 1:300@A3
ARCHITECT Bergstrom ARCHITECTS BERGSTROM ARCHITECTS PTY. LTD. (ABN 75 095 092 989) SUITE 103/3 EDEN STREET, NORTH SYDNEY NSW 2060 Ph. 02.8920.1499 Fax. 02.8920.1599		DRAWING PROPOSED ROOF PLAN	DRAWING NO. DA DA103
			REVISION B
			DATE: JUNE 2024 DRAWN BY: EO Job Number: 22-017

DA ISSUE

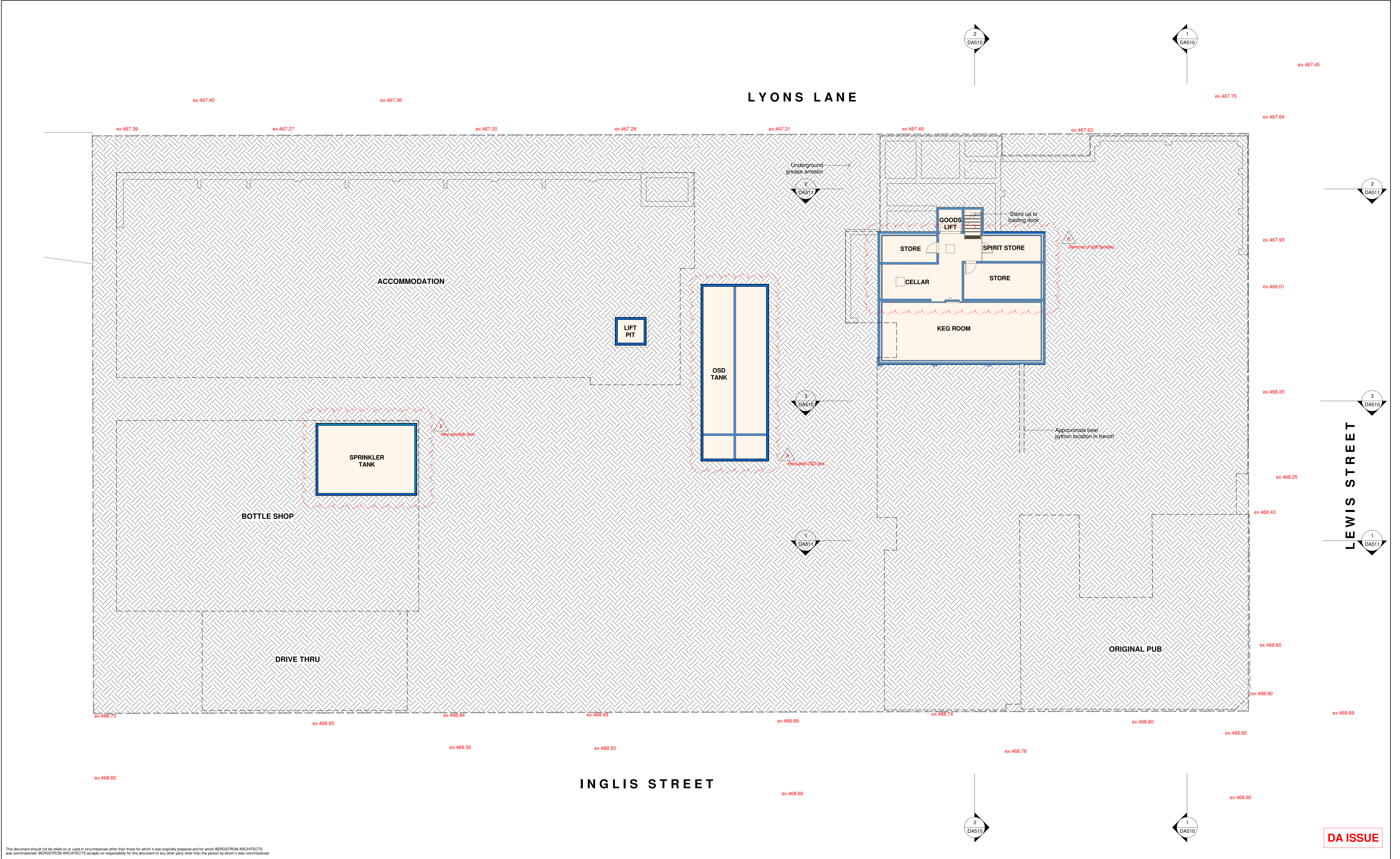

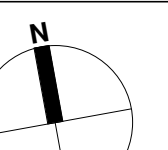

This document should not be relied on or used in circumstances other than those for which it was originally prepared and for which BERGSTROM ARCHITECTS was commissioned. BERGSTROM ARCHITECTS accepts no responsibility for this document to any other party other than the person by whom it was commissioned.

PROJECT ADDRESS 34 INGLIS STREET MUDGEE, NSW, 2850	<div> <div>1.50 0 1.5 3 4.5 6m</div></div>			<div><div>GENERAL NOTES:</div><div><div>1. DO NOT SCALE OFF DRAWINGS. USE ONLY FIGURED DIMENSIONS.</div><div>2. ALL DIMENSIONS ARE TO BE VERIFIED ON SITE PRIOR TO COMMENCEMENT OF ANY WORK.</div><div>3. ANY DISCREPANCIES ARE TO BE BROUGHT TO THE ATTENTION OF BERGSTROM ARCHITECTS PTY LTD BEFORE COMMENCEMENT OF ANY WORK.</div><div>4. ALL DIMENSIONS ARE GIVEN IN MILLIMETRES EXCEPT LEVELS &amp; DRAWINGS TO SCALE 1:500 AND SMALLER WHICH ARE IN METRES.</div><div>5. THIS DRAWING IS TO BE READ IN CONJUNCTION WITH RELEVANT CONSULTANTS DOCUMENTATION.</div><div>6. ALL DESIGNS, PRINTS &amp; SPECIFICATIONS ARE THE PROPERTY OF BERGSTROM ARCHITECTS PTY LTD &amp; MUST NOT BE ISSUED, USED OR REPRODUCED WITHOUT WRITTEN PREMISSION FROM BERGSTROM ARCHITECTS PTY LTD.</div></div></div>										<div><div>DA NOTES:</div><div><div>1. DRAWINGS ARE TO BE READ IN CONJUNCTION WITH THE DEVELOPMENT APPLICATION FORM AND STATEMENT OF ENVIRONMENTAL EFFECTS.</div><div>2. THE NEW BUILDING WORK IS TO BE CARRIED OUT IN ACCORDANCE WITH THE PROVISIONS OF THE BCA.</div><div>3. ALL NEW BUILDING WORK IS TO BE CARRIED OUT IN ACCORDANCE WITH THE NOTICE OF DETERMINATION FOR THIS DEVELOPMENT APPLICATION.</div><div>4. DISABILITY ACCESS AND FACILITIES TO BE IN ACCORDANCE WITH AS 1428.1 AND AS 1428.4</div><div>5. THE PROPOSED WORKS WILL ADDRESS FIRE SAFETY MEASURES TO COMPLY WITH THE PERFORMANCE REQUIREMENTS OF THE BCA (EITHER DEEMED TO SATISFY OR ALTERNATIVE SOLUTIONS TO BE PREPARED BY A QUALIFIED FIRE ENGINEER).</div><div>6. ALL MEANS OF EGRESS, EMERGENCY LIGHTING, EXIT SIGNS, FIRE DOORS, FIRE HYDRANT SYSTEMS, FIRE HOSE REEL SYSTEMS, PORTABLE FIRE EXTINGUISHERS, SMOKE AND HEAT VENTS, SMOKE DETECTION, ALARM AND EXHAUST SYSTEM TO BE IN ACCORDANCE WITH THE BCA AND OTHER RELEVANT AUSTRALIAN STANDARDS.</div></div></div>										<div><div><div><div>■</div>EXTENT OF NEW WORKS</div><div><div>■</div>EXTENT OF ALTERATIONS</div><div><div>■</div>EXISTING BUILDING TO REMAIN</div><div><div>■</div>NEW BUILDING WORK</div></div></div>										<div><div><div>B</div><div>A</div></div><div><div>17/02/2025</div><div>13/09/2023</div></div><div><div>S4.55 ISSUE</div><div>DA ISSUE</div></div></div>										<div><div>REVISIONS</div></div>										<div><div>CLIENT</div><div>IMG GROUP</div></div>										<div><div>PROJECT</div><div>22-017 FEDERAL HOTEL</div></div>										<div><div>SCALE</div><div>1:150@A1 1:300@A3</div></div>									
																																																			<div><div>DRAWING NO.</div><div>DA DA100</div></div>																																
																					<div><div>ARCHITECT</div><div><div><div></div>BergstromARCHITECTS</div><div>BERGSTROM ARCHITECTS PTY. LTD. (ABN 75 095 092 989) SUITE 103/3 EDEN STREET, NORTH SYDNEY NSW 2060 Ph. 02.8920.1499 Fax. 02.8920.1599</div></div></div>										<div><div>DRAWING</div><div>PROPOSED LOWER GROUND FLOOR PLAN</div></div>										<div><div>REVISION</div><div>B</div></div>										<div><div>DATE:</div><div>JUNE 2024</div></div>										<div><div>DRAWN BY:</div><div>EO</div></div>										<div><div>Job Number:</div><div>22-017</div></div>												