

## SEDIMENT CONTROL

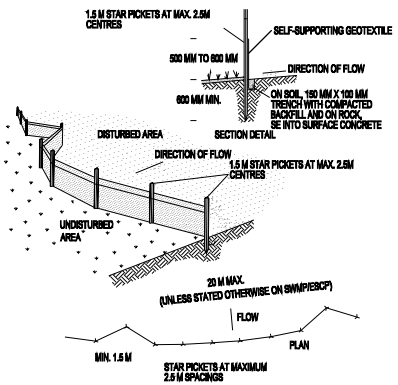

CONSTRUCTION NOTES

1. CONSTRUCTION NOTES
- a. CONSTRUCT SEDIMENT FENCES AS CLOSE AS POSSIBLE TO BEING PARALLEL TO THE CONTOURS OF THE SITE, BUT WITH SMALL DEVIATIONS AS SHOWN IN THE DRAWING TO OBTAIN THE CATCHMENT AREA OF ANY ONE SECTION. THE CATCHMENT AREA SHOULD BE SMALL ENOUGH TO LIMIT WATER FLOW IF CONCENTRATED AT ONE POINT TO 50 LITRES PER SECOND IN THE DESIGN STORM EVENT, USUALLY THE 10-YEAR EVENT.
- b. A 50-MM DEEP TRENCH ALONG THE UPSLOPE LINE OF THE FENCE FOR THE BOTTOM OF THE FABRIC TO BE ENTRENCHED.
- c. DRIVE 1.5 METRE LONG STAR PICKETS INTO GROUND AT 2.5 METRE INTERVALS (MAX) AT THE DOWNSLOPE END OF EACH SECTION TO ENSURE ANY STAR PICKETS ARE FITTED WITH SAFETY CAPS.
- d. FIX SELF-SUPPORTING GEOTEXTILE TO THE UPSLOPE SIDE OF THE POSTS ENSURING IT GOES TO THE BASE OF THE TRENCH. THE GEOTEXTILE MUST BE THE TYPE OF FABRIC RECOMMENDED BY THE MANUFACTURER. ONLY USE GEOTEXTILE SPECIFICALLY PRODUCED FOR SEDIMENT FENCING. THE USE OF SHADE CLOTH FOR THIS PURPOSE IS NOT SATISFACTORY.
- e. JOIN SECTIONS OF FABRIC AT A SUPPORT POST WITH A 50-MM OVERLAP.
- f. BACKFILL THE TRENCH OVER THE BASE OF THE FABRIC AND COMPACT IT THOROUGHLY OVER THE GEOTEXTILE.

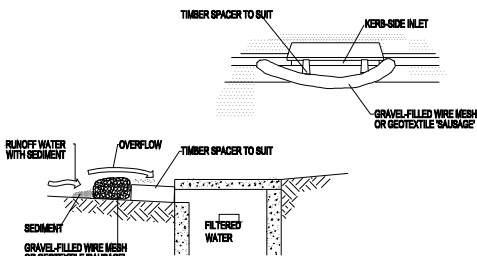

NOTE: THIS PRACTICE ONLY TO BE USED WHERE SPECIFIED IN AN APPROVED SYMPLISCP.

CONSTRUCTION NOTES

### CONSTRUCTION NOTES

1. INSTALL FILTERS TO KERB INLETS ONLY AT SAG POINTS.
2. FABRICATE A SLEEVE MADE FROM GEOTEXTILE OR WIRE MESH LONGER THAN THE LENGTH OF THE INLET PIT AND FILL IT WITH 25 MM TO 50 MM GRAVEL.
3. FORM AN ELLIPTICAL CROSS-SECTION ABOUT 150 MM HIGH X 400 MM WIDE.
4. PLACE THE FILTER AT THE OPENING LEAVING AT LEAST A 100-MM SPACE BETWEEN IT AND THE KERB INLET. MAINTAIN THE OPENING WITH SPACER BLOCKS.
5. FORM A SEAL WITH THE KERB TO PREVENT SEDIMENT BYPASSING THE FILTER.
6. SANDBAGS FILLED WITH GRAVEL CAN SUBSTITUTE FOR THE MESH OR GEOTEXTILE PROVIDING THEY ARE PLACED SO THAT THEY FIRMLY ABUT EACH OTHER AND SEDIMENT-LADEN WATERS CANNOT PASS BETWEEN.

## SITE NOTES

- CONFIRM ALL DIMENSIONS ON SITE TO EXISTING RESIDENCE PRIOR TO COMMENCEMENT OF ANY WORK.
- THIS PLAN DOES NOT PROVIDE SPECIFIC LANDSCAPE PLANTING LOCATIONS.
- THE EXACT LOCATION OF UNDERGROUND AND ABOVEGROUND SERVICES SHALL BE PROVEN ON SITE. NO GUARANTEE IS GIVEN THAT ALL EXISTING SERVICES ARE SHOWN.
- THIS DRAWING SET TO BE READ IN CONJUNCTION WITH THE SPECIFICATION PROVIDED.
- BEWARE OF EXISTING SERVICES. CONFIRM LOCATIONS PRIOR TO EXCAVATION. TAKE EXTREME CARE.

LEGEND

-  TEMPORARY SITE MATERIAL DISPOSAL ARE DURING CONSTRUCTION. TO BE PROTECTED BY A SEDIMENT FENCE OR STRAW BALE FILTER.
-  SITE ACCESS DURING CONSTRUCTION.

## SITE COVERAGE

|  |                          |
|--|--------------------------|
| <u>LOT 803 DAVIS CRESCENT, CAERLEON</u>    | = 1,045.00M <sup>2</sup> |
| <u>SITE COVERAGE</u>                       |                          |
| TOTAL GFA EXCLUDING PORCH & ALFRESCO AREAS | = 296.20M <sup>2</sup>   |
|  | = 28.34%                 |
| <u>LANDSCAPING</u>                         |                          |
| LANDSCAPING - INCLUDING GRAVEL AREAS       | = 748.80M <sup>2</sup>   |
| <u>LESS</u> TOTAL DRIVEWAY & PATHWAYS      | = 63.20M <sup>2</sup>    |
|  | = 685.60M <sup>2</sup>   |
|  | = 65.60%                 |

## SUBDIVISION NOTES

|  |                          |
|--|--------------------------|
| LOT 803 DAVIS CRESCENT, CAERLEON           |                          |
| DP 1273341 - ZONING R1 GENERAL RESIDENTIAL |                          |
| <hr/>                                      |                          |
| TOTAL LOT 803 AREA                         | = 1,045.00M <sup>2</sup> |
| PROPOSED LOT 1 (DWELLING ONE)              | = 525.00M <sup>2</sup>   |
| PROPOSED LOT 2 (DWELLING TWO)              | = 520.00M <sup>2</sup>   |

- CONFIRM ALL DIMENSIONS BACK TO SPECIFIC SURVEY PLANS PRIOR TO COMMENCEMENT OF ANY WORK.
- PROPOSED DIVIDING SUBDIVISION BOUNDARY IS APPROXIMATE ONLY AND TO BE CONFIRMED AS ABOVE.
- PROPOSED LOT AREAS ARE APPROXIMATE ONLY & SHOULD BE READ IN CONJUNCTION WITH SPECIFIC SURVEY PLANS.

## LANDSCAPING DETAILS

SMALL SHRUBS TO 1.0M HIGH

- SURFER BOY (PHORMIUM)
- BRONZE BABY (PHORIUM)
- GOLF BABY (PITTOSPORIUM)

SMALL ORNAMENTAL TREES TO 3.0M HIGH

- MANCHURIAN PEAR (PYRUS USSURIENSIS)

CONSULT LOCAL NURSERY FOR AVAILABILITY AND SUITABILITY OF THE SPECIES LISTED § SUBSTITUTE SIMILAR PLANTING IF REQUIRED.  
MULCH BEDS WITH WOODCHIP OR PEBBLES § FILL OUT OR LINE BEDS WITH GROUND COVERS OR SIMILAR SMALL PLANTS.  
EDGE BEDS WITH INSITU FORMED CONCRETE ROLLED EDGE, SLEEPERS, MASONRY BLOCK EDGING OR SIMILAR AS SELECTED.

KIKUYU TURF TO ALL AREAS, UNLESS GRAVEL IS STATED AND DISPLAYED OTHERWISE.

AT BUILDERS DISCRETION SUBSTITUTE SHRUBS AND TREES MAY BE USED TO REPLACE THE ABOVE MENTIONED SPECIES AND ALSO THE LOCATION OF GARDEN BEDS, SHOULD THE SITE LEAD TO AN ALTERNATIVE / MORE SUITABLE OPTION.

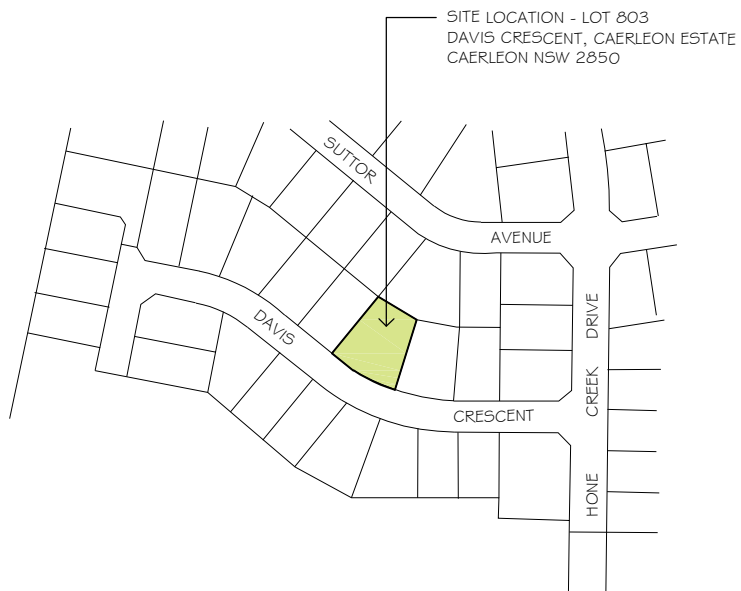

## LOCATION PLAN

SCALE: 1:NTS

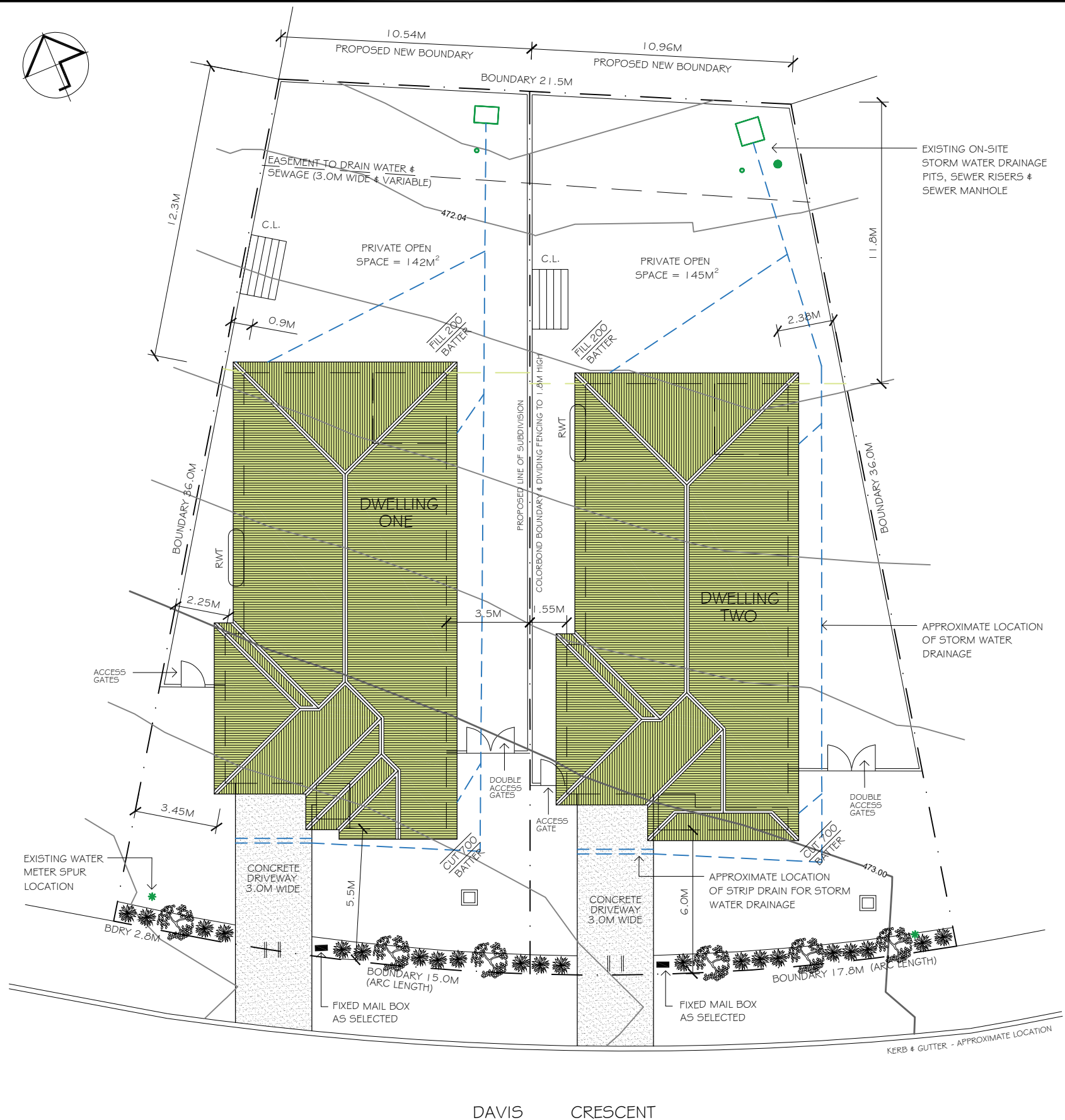

## SITE, LANDSCAPE & SUBDIVISION PLAN

SCALE: 1:200

| REV | DATE       | DESCRIPTION              | NOTE:  |
|-----|------------|--------------------------|--|
| A   | 07/06/2023 | CONCEPT PLANS FOR REVIEW | ALL DRAWINGS TO BE READ IN CONJUNCTION WITH -<br>- ALL SHEETS TO THIS SET OF PLANS<br>- SEPERATE SPECIFICATION DOCUMENTS<br>- STRUCTURAL ENGINEERS DOCUMENTATION<br>- PCA DOCUMENTS (WHERE APPLICABLE)<br>- BASIX CERTIFICATE<br>- ALL RELEVANT CODES, STANDARDS & APPROVALS |
| B   | 24/07/2023 | PRELIM PLANS FOR QUOTING |  |
| C   | 14/08/2023 | PRELIM PLANS FOR QUOTING |  |
| D   | 13/09/2023 | CONTRACT PLANS FINALISED |  |
| E   | 30/09/2023 | FINAL PLANS              |  |



**BUILDING DESIGNERS**  
ASSOCIATION OF AUSTRALIA

LYNCH BUILDING GROUP  
CLIENT:  
PROPOSED DETACHED DUAL  
OCCUPANCY  
LOT 803 DAVIS CRESCENT  
CAERLEON NSW 2850  
PROJECT:



**LYNCH BUILDING**  
GROUP

POSTAL:  
PO BOX 1298  
Mudgee NSW 2850

CONTACT US:  
P. 02 63726 054  
E. [projects@lynchbuildinggroup.com.au](mailto:projects@lynchbuildinggroup.com.au)  
[WWW.LYNCHBUILDINGGROUP.COM.AU](http://WWW.LYNCHBUILDINGGROUP.COM.AU)

LOCATION, SITE, SUBDIVISION &amp; LANDSCAPE PLAN

|                  |                   |             |      |
|------------------|-------------------|-------------|------|
| DRAWING TITLE:   |                   |             |      |
| DESIGN: LBG      | FILE NO: 0494-A01 | 02 OF 09    | E    |
| DRAFTED: J.LYNCH | PAPER SIZE: A3    | DRAWING NO: | REV: |
| CHECKED: A.LYNCH |                   |             |      |