

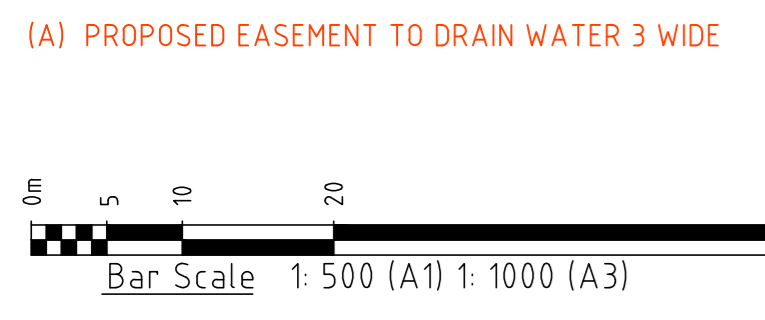

### LEGEND

	BOUNDARY LINE
	ADJACENT BOUNDARY
	EASEMENT
	FENCE LINE
	OVERHEAD POWER LINE
	UNDERGROUND WATER LINE
	UNDERGROUND TELECOMMUNICATIONS LINE
	POWER POLE
	ELECTRICITY PYLON



- NOTES:**
1. FEATURES SHOWN TO SCALE ACCURACY.
  2. THIS PLAN IS SUITABLE FOR DETAILED PLANNING AND DESIGN AT THE SCALE/S STATED. THE PLAN MAY NOT BE SUITABLE FOR ANY OTHER PURPOSE OR FOR USE AT ANY OTHER SCALE/S.
  3. CONTOUR INTERVAL: 0.5m.
  4. THE BOUNDARIES SHOWN ARE APPROXIMATE ONLY. THE BOUNDARIES SHOWN HAVE BEEN COMPILED FROM THE RELEVANT DEPOSITED PLANS. FURTHER SURVEY WILL BE REQUIRED IF CONSTRUCTION IS TO TAKE PLACE ON OR ADJACENT TO THE BOUNDARIES.
  5. DURING THE COURSE OF THIS SURVEY NO INVESTIGATION HAS BEEN UNDERTAKEN TO DETERMINE THE EXISTENCE OF ANY POSSIBLE SUBTERRANEAN ENCROACHMENTS.

H	G	F	E	D	C	B	A
				31.01.23	20.01.23	19.08.22	14.03.22
				MODIFICATION SUBMISSION	MODIFICATION SUBMISSION	DA SUBMISSION	INITIAL ISSUE
Ed.	Date	Amendment					

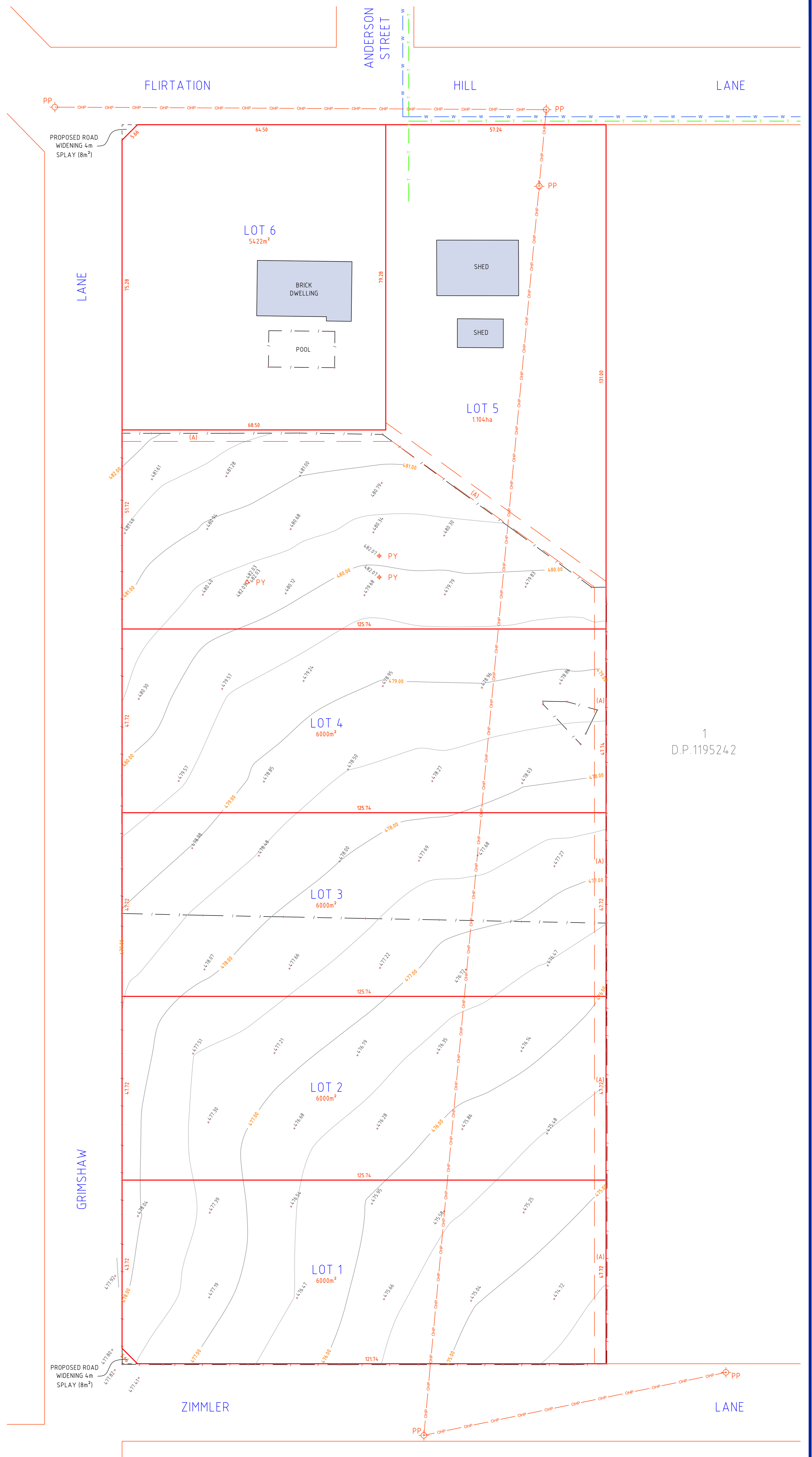

1  
D.P.1195242

THIS PLAN IS COPYRIGHT AND SHALL REMAIN THE PROPERTY OF DE WITT CONSULTING. THE CLIENT NAMED ON THE PLAN IS GRANTED A LICENCE TO USE THE INFORMATION. USING THE INFORMATION CONTAINED IN THIS PLAN IS PROHIBITED UNLESS WRITTEN APPROVAL IS GRANTED BY DE WITT CONSULTING. THE PLAN AND INFORMATION MAY ONLY BE USED FOR THE PURPOSE FOR WHICH THE PLAN WAS DESIGNED.

**de Witt Consulting**  
planning ■ surveying ■ project management

**HUNTER REGION**  
7 Canberra Street Charlestown  
PO Box 850 Charlestown NSW 2290  
P 02 4942 5441 F 02 4942 5301  
E admin@de Wittconsulting.com.au

**WESTERN REGION**  
87 Herbert Street Gulgong  
PO Box 232 Gulgong NSW 2852  
P 02 6374 2911 F 02 6374 2922  
ABN 23 104 067 405

TITLE	PROPOSED SUBDIVISION OF LOT 158 D.P.755433	
JOB ADDRESS:	6 FLIRTATION HILL LANE, GULGONG	
CLIENT:	LEE & JAN CUNNINGHAM	
SCALE:	A1 1:500 A3 1:1000	
SURVEY DATE:	N/A	
PLAN DATE:	31.01.23	
DATUM:	-	
CAD REF:	13119-MF220817	

REV	D	JOB REF:	13119
ORIGIN OF LEVELS	N/A	DRAWN	PDM
		SURVEYOR	CHECKED
		JL	APPROVED
		JL	
SHEET No	1/1		
DRAWING REF:	13119-PROPOSED SUBDIVISION-31.1.23		