



MUDGEE - DUNEDOO RAILWAY  
 LOT 4307  
 LANE

DOURO STREET

DP1133121

LOT 137

LYONS

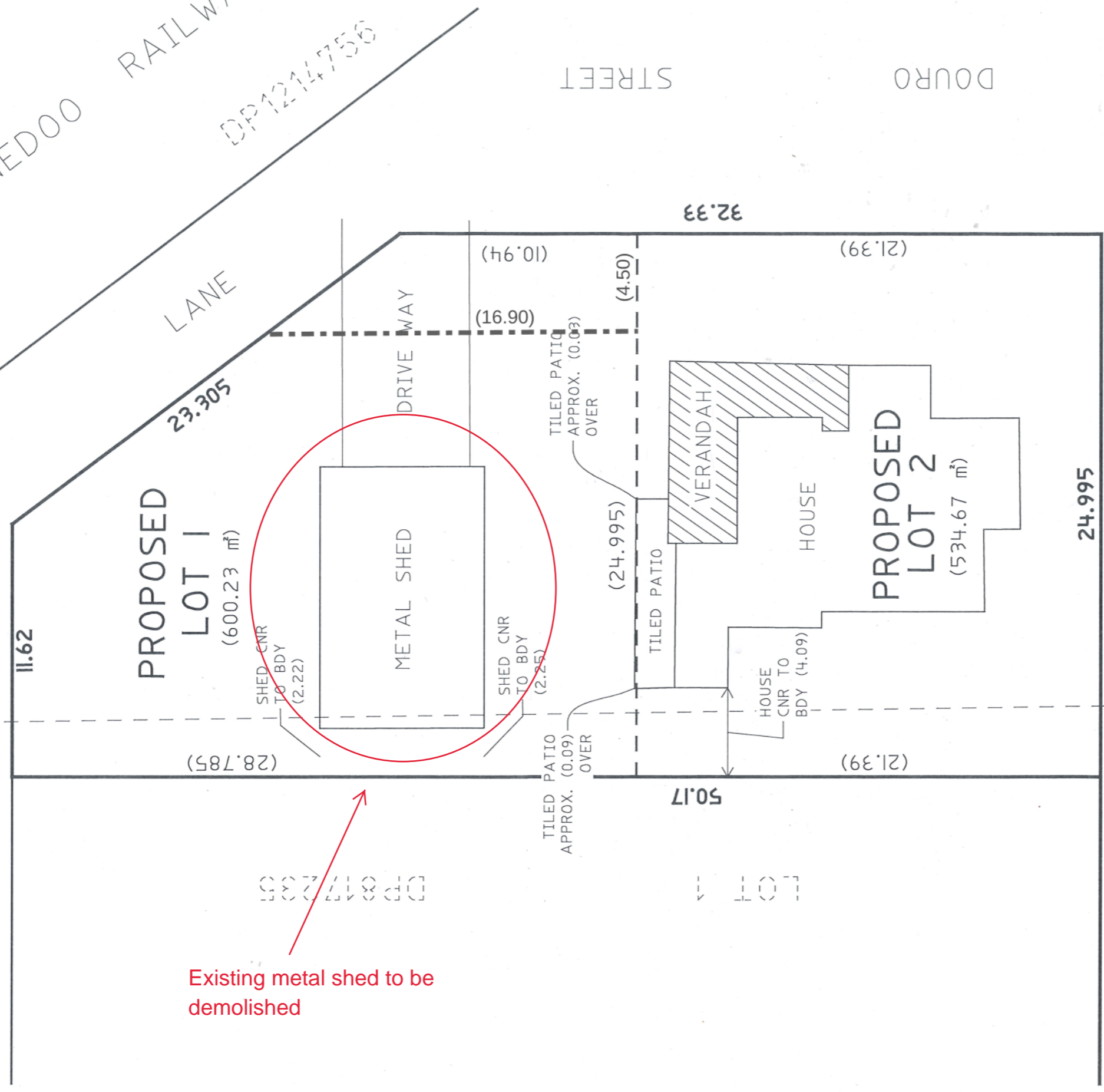

Existing metal shed to be demolished

--- DENOTES PROPOSED BOUNDARY  
 SERVICES SHOWN HAVE BEEN DERIVED FROM VISUAL EVIDENCE APPARENT AT THE TIME OF SURVEY, SERVICES MAY EXIST WHICH ARE NOT SHOWN.  
 USE STATED DIMENSIONS. DO NOT SCALE.  
 IT IS ADVISABLE TO CALL 1100, "DIAL BEFORE YOU DIG" BEFORE CARRYING OUT ANY BUILDING WORKS  
 PROPOSED LOT DIMENSIONS AND AREAS ARE SUBJECT TO FINAL SURVEY

PHILIP MARTEN ORR  
 OF O'RYAN GEOSPATIAL PTY LTD  
 SURVEYOR REGISTERED UNDER THE SURVEYING AND SPATIAL INFORMATION ACT 2002  
 THIS PLAN IS OF AN IDENTIFICATION SURVEY ONLY, AND AS SUCH IS NOT EXAMINED FOR REGISTRATION BY LAND REGISTRY SERVICES. NO RESPONSIBILITY CAN THEREFORE BE ACCEPTED FOR ANY FUTURE DIFFERENCE IN BOUNDARY DEFINITION WHICH MAY RESULT FROM RE-SURVEY OF ADJOINING LANDS OR SUBSEQUENT REGISTRATION OF NEW SURVEY PLANS.

No.	DATE	REVISION	DETAILS	CLIENT: LUKE COSSETTO 74 INGLIS STREET MUDGEE				SCALE: 1:200 @ A3 CONTOUR INTERVAL N / A	DATUM: AHD	TITLE: PROPOSED SUBDIVISION OVER LOT 2 DP817235, KNOWN AS 74 INGLIS STREET MUDGEE	REVISION: 0
				DRAWN: AWB		CHECKED: DSR		DWG No: 22-930-DA	JOB No: 22-930	SHEET 1 OF 1 SHEET(S)	



INGLIS STREET