

PROPOSED BUNNINGS DEVELOPMENT

LIONS DRIVE

MUDGEEE, NSW

BUNNINGS GROUP LIMITED

NOTES:

- 1. ALL DIMENSIONS OF EASEMENTS AND LOTS ARE SUBJECT TO REGISTRATION OF DEPOSITED PLAN.
- 2. ALL WORK TO BE CARRIED OUT IN ACCORDANCE WITH COUNCIL'S CONSTRUCTION SPECIFICATION & CODE.
- 3. EROSION CONTROL DEVICES AND SILTATION TRAPS TO BE INSTALLED BEFORE SITE IS DISTURBED IN ACCORDANCE WITH THE ATTACHED SILTATION PLAN.
- 4. DENUDED AREAS TO BE REGRASSED ON COMPLETION OF WORKS.
- 5. ALL REINFORCED CONC. STORMWATER DRAINAGE PIPES ARE TO BE RUBBER RING JOINTED.
- 6. ALL PITS DEEPER THAN 1.2m ARE TO BE CONSTRUCTED WITH STEP IRONS.
- 7. SIDE WALLS OF ALL PITS GREATER THAN 1.5m DEEP SHALL BE REINFORCED WITH ONE LAYER OF SL92 MESH RETURNED 300mm INTO BASE.
- 9. ALL EXISTING UNDERGROUND SERVICES MUST BE LOCATED AND EXPOSED PRIOR TO EARTHWORKS COMMENCING AND IT IS THE RESPONSIBILITY OF THOSE PERSONS USING THIS PLAN TO CONFIRM BOTH POSITION & LEVEL OF THESE UTILITIES IN CONJUNCTION WITH THE APPROPRIATE AUTHORITY.
- 10. SUBSOIL DRAINS ARE TO BE PROVIDED TO COUNCIL INSPECTOR'S REQUIREMENTS. FLUSH POINTS TO BE PROVIDED AT MAXIMUM 60.0m INTERVALS.
- 12. WORKING HOURS ON SITE SHALL BE IN ACCORDANCE WITH EPA & COUNCIL REQUIREMENTS.
- 13. VEHICULAR ACCESS AND ALL SERVICES ARE TO BE MAINTAINED AT ALL TIMES TO ADJOINING PROPERTIES AFFECTED BY CONSTRUCTION WORKS.
- 16. MAINTENANCE ON THE SEEDED AND TURFED AREAS SHALL BE OVER A 3 MONTH PERIOD. TURF THE FULL WIDTH OF ALL EARTH DISH DRAINS. LAY 600mm WIDE TURF STRIPS TO EACH SIDE OF CONCRETE ACCESSWAYS, PATHWAYS, AT THE REAR OF ALL KERB AND GUTTERING AND AT THE TOP OF CUT BATTERS. MULCH (IF AVAILABLE FROM SITE CLEARING) AND SEED ALL OTHER DISTURBED AREAS, INCLUDING TRENCHES.
- 17. TRAFFIC CONTROL MEASURES TO BE IN ACCORDANCE WITH AS 1742.3-1996.
- 18. ALL LEVELS MUST BE OBTAINED FROM ESTABLISHED BENCH MARKS AS DIRECTED BY THE SUPERVISOR.
- 19. THE CONTRACTOR IS TO ENSURE THAT ALL THE NECESSARY SERVICE PIPE CONDUITS AND FITTINGS ARE IN PLACE PRIOR TO THE FINAL WEARING COURSE BEING LAID.
- 20. PROVIDE STREET NAME SIGNS AT ALL INTERSECTIONS, DOUBLE BLADED WHERE NECESSARY.
- 21. ALL SITE FILLING TO BE CONTROLLED FILL TO AS3798 WITH TESTING TO BE CARRIED OUT BY A NATA REGISTERED LABORATORY.
- 22. PAVEMENT PROOF ROLLING AND LEVEL CHECKS TO BE IN ACCORDANCE WITH STANDARD COUNCIL REQUIREMENTS.

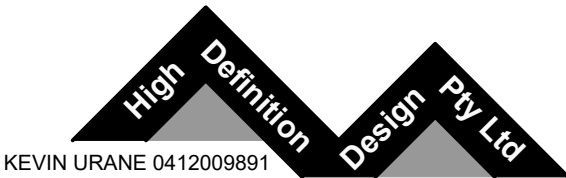

KEVIN URANE 0412009891

Project No:		HD259
Date:		26 MAY 2022
DWG No.	SHEET TITLE	REV
HD00	COVER SHEET	7
HD01	OVERALL SITE PLAN	7
HD02	BUNNINGS LOT SITE PLAN	7
HD03	AERIAL OVERLAY ROAD WORKS	7
HD04	OVERALL ROAD WORKS PLAN	7
HD05	ROAD WORKS PLAN SHEET 1 OF 2	7
HD06	ROAD WORKS PLAN SHEET 2 OF 2	7
HD07	CHANNEL LONG SECTION	7
HD08	CHANNEL TYPICAL SECTIONS	7
HD09	DRIVEWAY 1 AND 2 LONGITUDINAL SECTION	7
HD10	CATCHMENT PLAN	7
HD11	BASIN PLAN	7
HD12	VEHICLE TURNING MOVEMENTS INTERSECTION 1 OF 3	7
HD13	VEHICLE TURNING MOVEMENTS INTERSECTION 2 OF 3	7
HD14	VEHICLE TURNING MOVEMENTS INTERSECTION 3 OF 3	7
HD15	EROSION AND SEDIMENTATION CONTROL PLAN	7
HD16	EROSION AND SEDIMENTATION CONTROL DETAILS	7
HD17	TREE REMOVAL DEMOLITION PLAN	7

DEVELOPMENT APPLICATION ISSUE

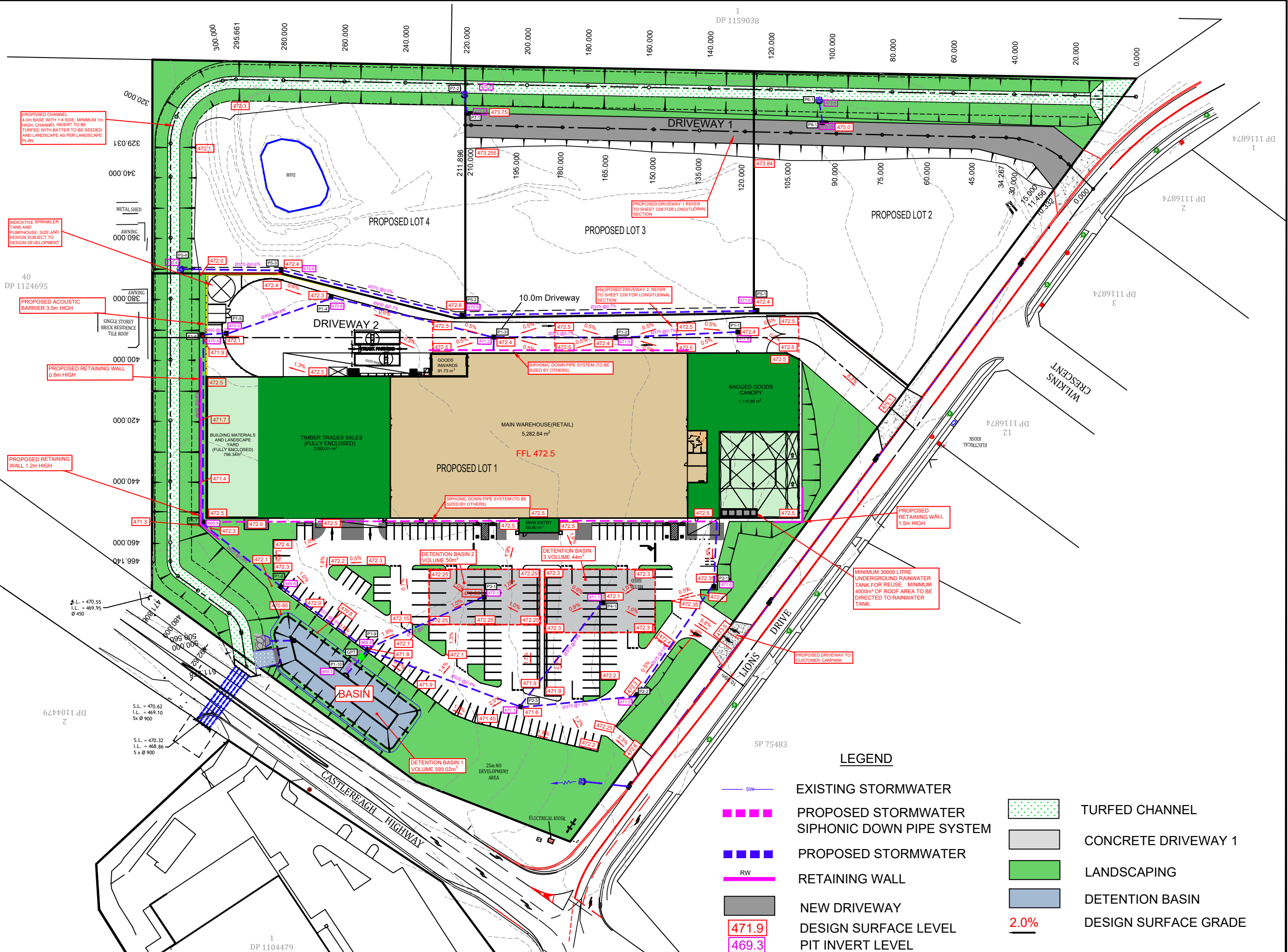

www.dialbeforeyoudig.com.au



TITLE: PROPOSED BUNNINGS DEVELOPMENT
CNR CASTLEREAGH HIGHWAY AND LIONS DRIVE
MUDGEE LOT 2 DP1079362

OVERALL PLAN SHEET

CLIENT: BUNNINGS GROUP LIMITED



KEVIN URANE 0412009891

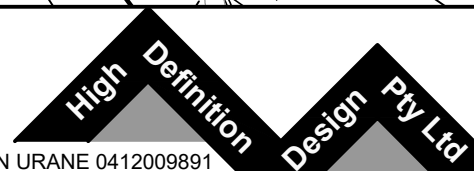

NOTE:

ALL EXISTING UNDERGROUND SERVICES MUST BE LOCATED AND EXPOSED PRIOR TO EARTHWORKS COMMENCING AND IT IS THE RESPONSIBILITY OF THOSE PERSONS USING THIS PLAN TO CONFIRM BOTH POSITION AND LEVEL OF THESE UTILITIES IN CONJUNCTION WITH THE APPROPRIATE AUTHORITY.

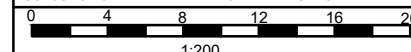

LEGEND

- | | | | |
|--------|---|--|----------------------|
| — SW — | EXISTING STORMWATER | | TURFED CHANNEL |
| | PROPOSED STORMWATER SIPHONIC DOWN PIPE SYSTEM | | CONCRETE DRIVEWAY 1 |
| | PROPOSED STORMWATER | | LANDSCAPING |
| | RETAINING WALL | | DETENTION BASIN |
| | NEW DRIVEWAY | | DESIGN SURFACE GRADE |
| | DESIGN SURFACE LEVEL | | |
| | PIT INVERT LEVEL | | |

Date:	15.06.15	Scale:	1:600 A1	Designed:	KU	Project No:	HD259
Cad Ref:	HD259 r7					Drawing No:	HD01
7	DA ISSUE			KU	23.06.22	Revision:	7
6	CLIENT DA ISSUE			KU	26.05.22		
5	CONCEPT INTERSECTION LAYOUT			KU	28.04.22		
No	Amendment			Drawn	Date		

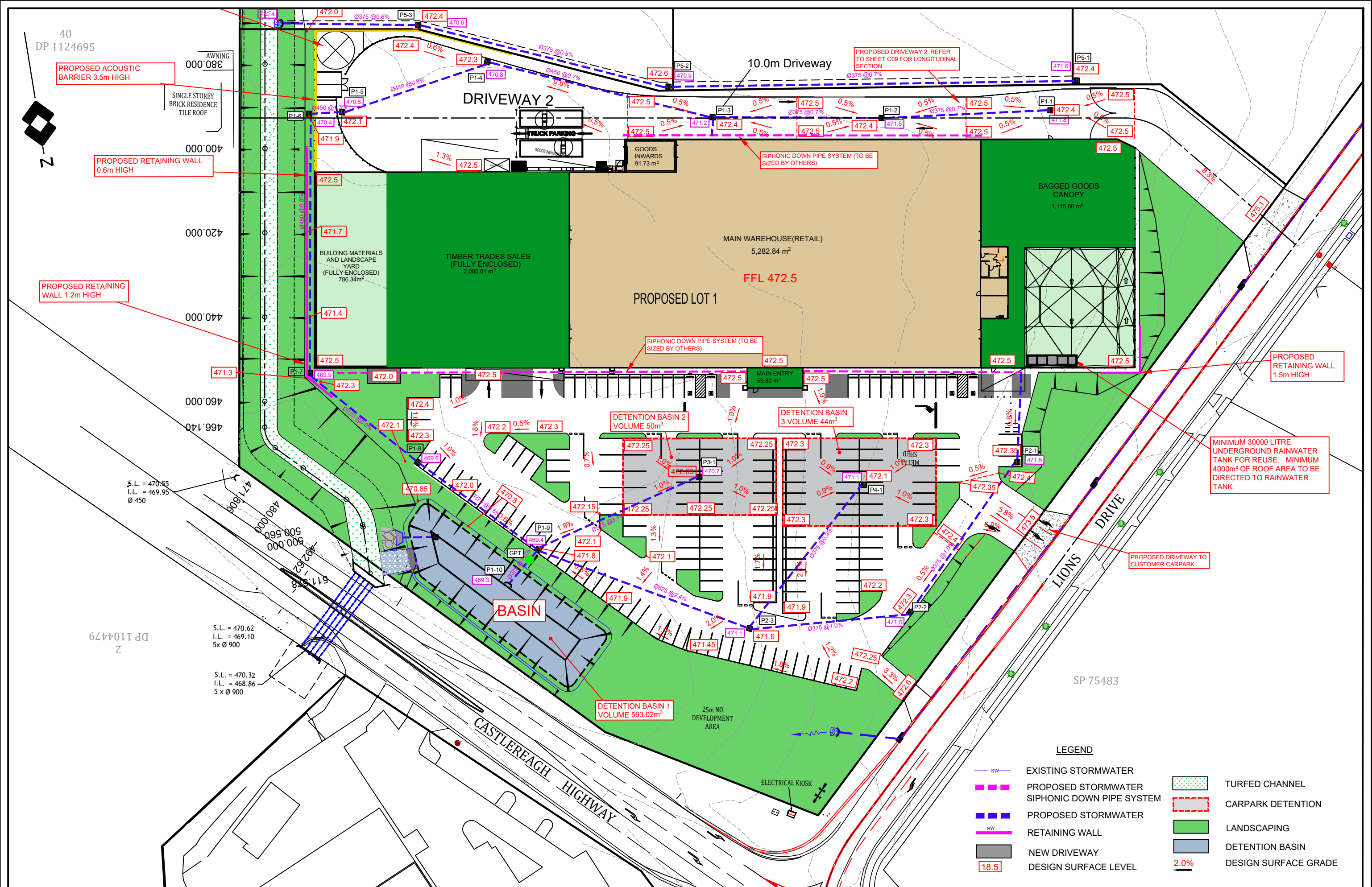



TITLE: PROPOSED ROAD WORKS
CNR CASTLEREAGH HIGHWAY AND LIONS DRIVE
MUDGEE
AERIAL OVERLAY
CLIENT: BUNNINGS GROUP LIMITED



KEVIN URANE 0412009891



NOTE:
ALL EXISTING UNDERGROUND SERVICES MUST BE LOCATED
AND EXPOSED PRIOR TO EARTHWORKS COMMENCING AND IT IS
RESPONSIBILITY OF THOSE PERSONS USING THIS PLAN TO
CONFIRM BOTH POSITION AND LEVEL OF THESE UTILITIES IN
CONJUNCTION WITH THE APPROPRIATE AUTHORITY.

0 4 8 12 16 20 m
1:200

Date:	15.06.15	Scale:	1:200 A1	Designed:	KU	Project No	HD259	
Cad Ref:	HD259 r7					Drawing No	HD03	Revision
7	DA ISSUE			KU	23.06.22			
6	CLIENT DA ISSUE			KU	26.05.22			
5	CONCEPT INTERSECTION LAYOUT			KU	28.04.22			
No	Amendment			Drawn	Date			

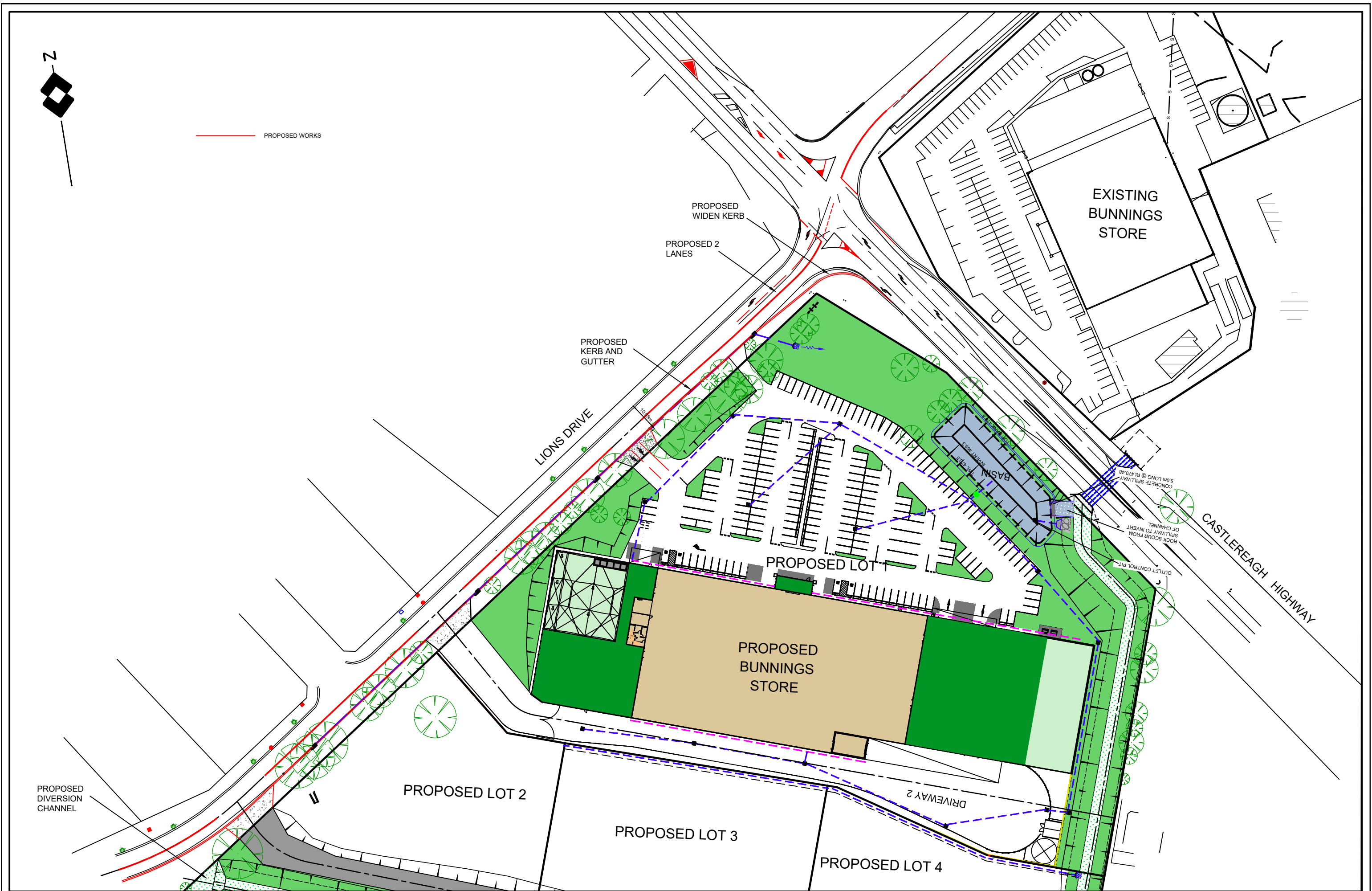

TITLE: PROPOSED ROAD WORKS
CNR CASTLEREAGH HIGHWAY AND LIONS DRIVE
MUDGEE
ROAD WORKS OVERALL PLAN
CLIENT: BUNNINGS GROUP LIMITED

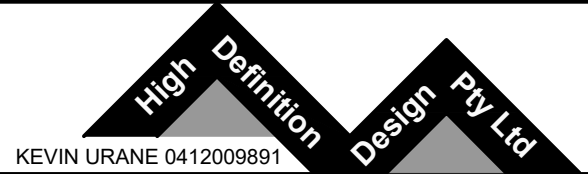

NOTE:
ALL EXISTING UNDERGROUND SERVICES MUST BE LOCATED AND EXPOSED PRIOR TO EARTHWORKS COMMENCING AND IT IS RESPONSIBILITY OF THOSE PERSONS USING THIS PLAN TO CONFIRM BOTH POSITION AND LEVEL OF THESE UTILITIES IN CONJUNCTION WITH THE APPROPRIATE AUTHORITY.

Date:	15.06.15	Scale:	1:500 A1	Designed:	KU	Project No	HD259	
Cad Ref:	HD259 r7					Drawing No	HD04	Revision
7	DA ISSUE			KU	23.06.22			
6	CLIENT DA ISSUE			KU	26.05.22			
5	CONCEPT INTERSECTION LAYOUT			KU	28.04.22			
No	Amendment			Drawn	Date			

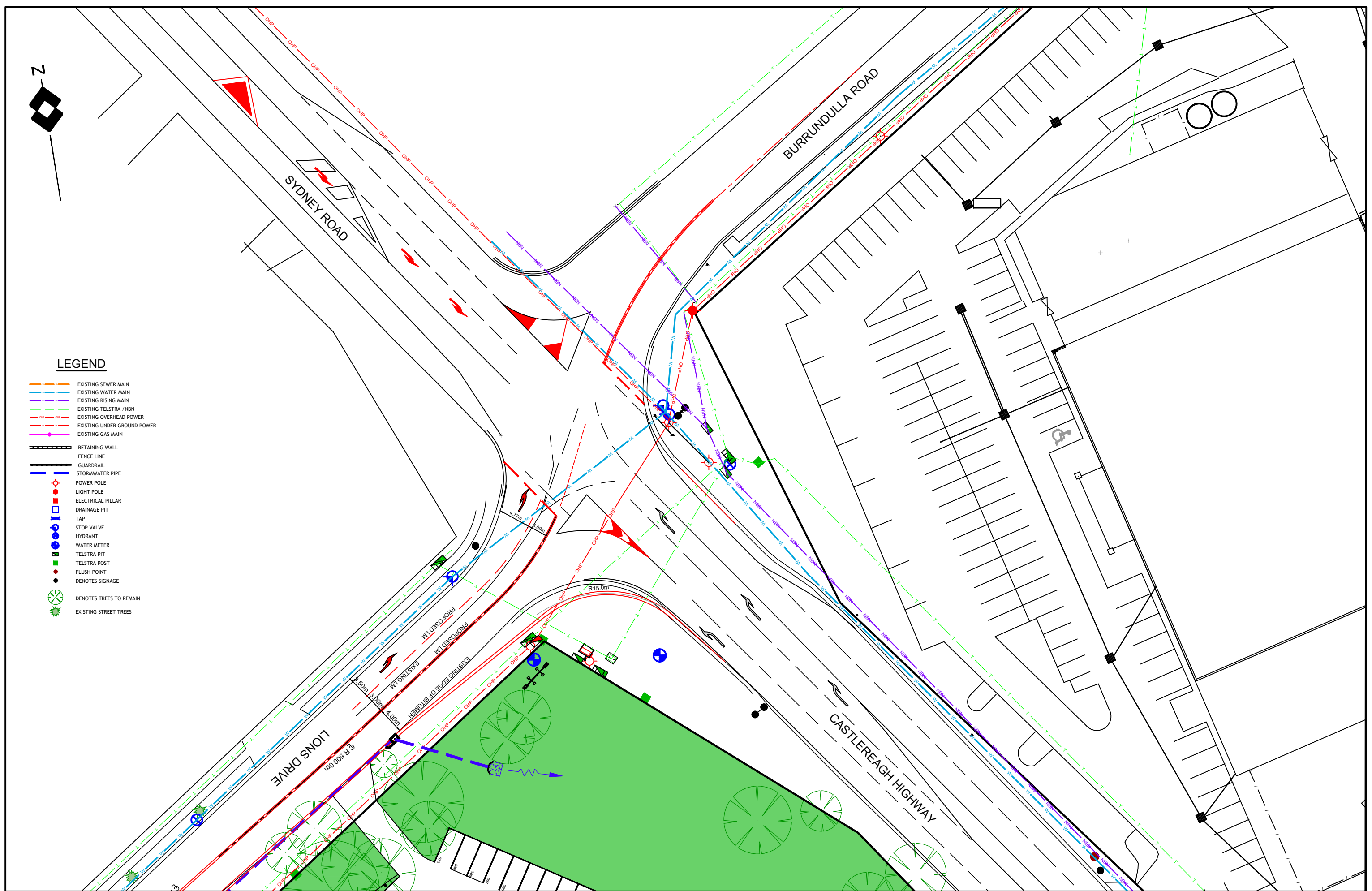

LEGEND

- EXISTING SEWER MAIN
- EXISTING WATER MAIN
- EXISTING RISING MAIN
- EXISTING TELSTRA / NBN
- EXISTING OVERHEAD POWER
- EXISTING UNDER GROUND POWER
- EXISTING GAS MAIN
- RETAINING WALL
- FENCE LINE
- GUARDRAIL
- STORMWATER PIPE
- POWER POLE
- LIGHT POLE
- ELECTRICAL PILLAR
- DRAINAGE PIT
- TAP
- STOP VALVE
- HYDRANT
- WATER METER
- TELSTRA PIT
- TELSTRA POST
- FLUSH POINT
- DENOTES SIGNAGE
- DENOTES TREES TO REMAIN
- EXISTING STREET TREES

TITLE: PROPOSED ROAD WORKS
CNR CASTLEREAGH HIGHWAY AND LIONS DRIVE
MUDGEE
ROAD WORKS DETAIL PLAN 1 OF 2
CLIENT: BUNNINGS GROUP LIMITED



High Definition Design Pty Ltd
KEVIN URANE 0412009891

NOTE:
ALL EXISTING UNDERGROUND SERVICES MUST BE LOCATED AND EXPOSED PRIOR TO EARTHWORKS COMMENCING AND IT IS RESPONSIBILITY OF THOSE PERSONS USING THIS PLAN TO CONFIRM BOTH POSITION AND LEVEL OF THESE UTILITIES IN CONJUNCTION WITH THE APPROPRIATE AUTHORITY.

Date:	15.06.15	Scale:	1:250 A1	Designed:	KU	Project No:	HD259
Cad Ref:	HD259 r7					Drawing No:	HD05
7	DA ISSUE			KU	23.06.22	Revision:	7
6	CLIENT DA ISSUE			KU	26.05.22		
5	CONCEPT INTERSECTION LAYOUT			KU	28.04.22		
No	Amendment			Drawn	Date		

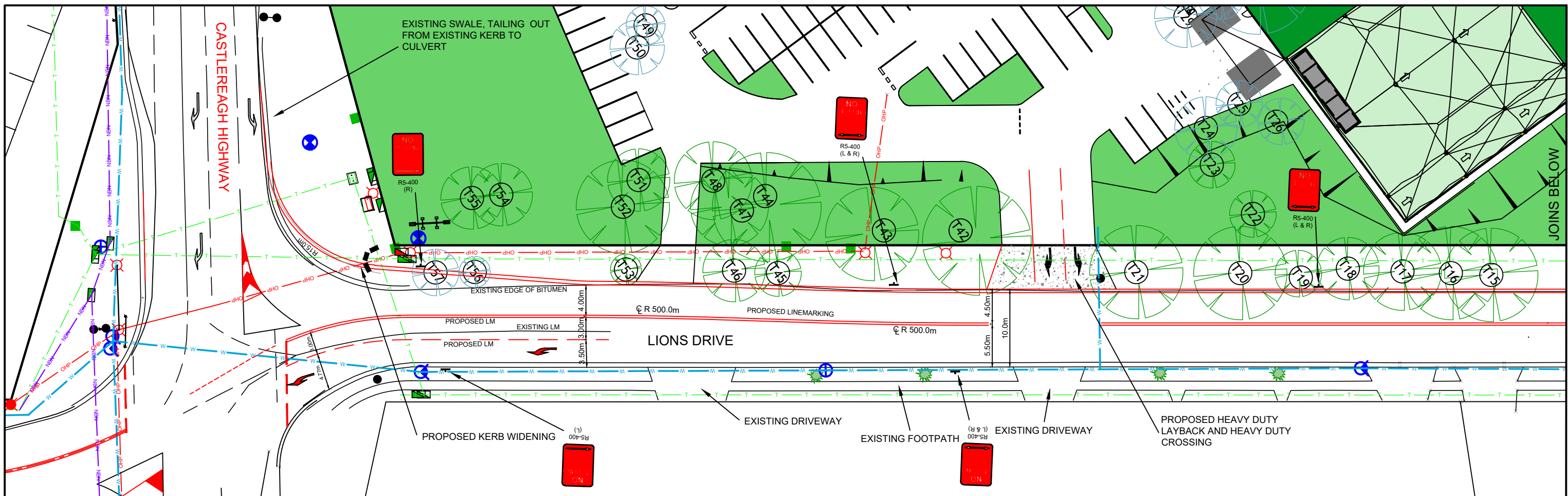

LEGEND

- EXISTING SEWER MAIN
- EXISTING WATER MAIN
- EXISTING RISING MAIN
- EXISTING TELSTRA /NBN
- EXISTING OVERHEAD POWER
- EXISTING UNDER GROUND POWER
- EXISTING GAS MAIN
- POWER POLE
- LIGHT POLE
- ELECTRICAL PILLAR
- WATER METER
- TELSTRA PIT
- TELSTRA POST
- RETAINING WALL
- FENCE LINE
- GUARDRAIL
- STORMWATER PIPE
- DRAINAGE PIT
- TAP
- STOP VALVE
- HYDRANT
- FLUSH POINT
- DENOTES SIGNAGE
- DENOTES TREE TOP REMOVE

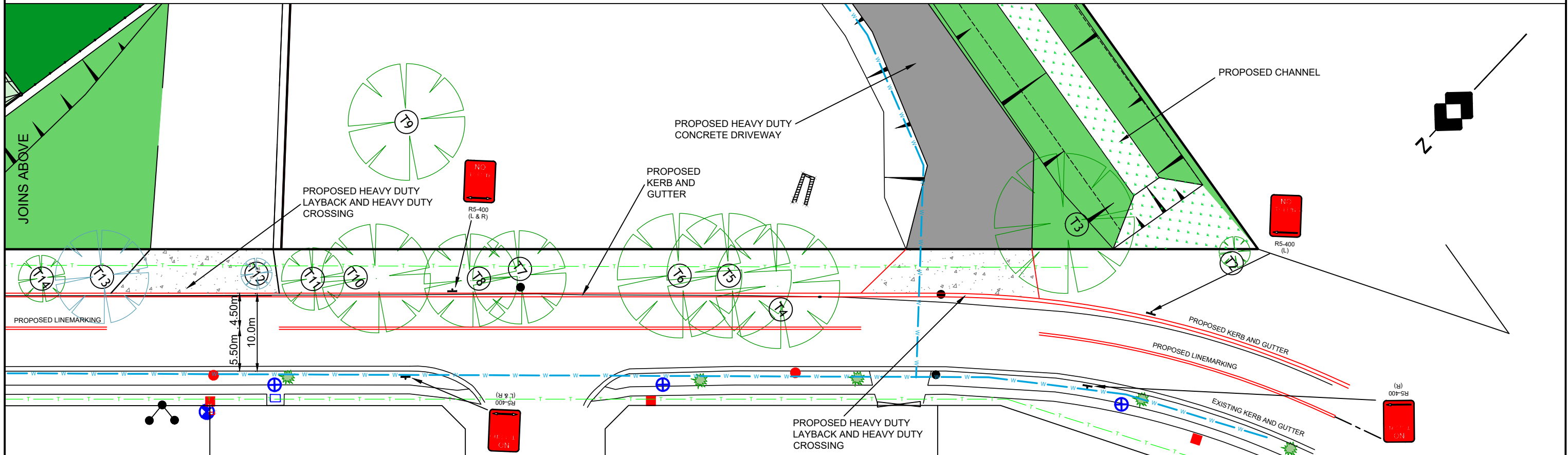

TITLE: PROPOSED ROAD WORKS
CNR CASTLEREAGH HIGHWAY AND LIONS DRIVE
MUDGEES
ROAD WORKS DETAIL PLAN 2 OF 2
CLIENT: BUNNINGS GROUP LIMITED



KEVIN URANE 0412009891



NOTE:
ALL EXISTING UNDERGROUND SERVICES MUST BE LOCATED AND EXPOSED PRIOR TO EARTHWORKS COMMENCING AND IT IS RESPONSIBILITY OF THOSE PERSONS USING THIS PLAN TO CONFIRM BOTH POSITION AND LEVEL OF THESE UTILITIES IN CONJUNCTION WITH THE APPROPRIATE AUTHORITY.

Date:	15.06.15	Scale:	1:250 A1	Designed:	KU	Project No	HD259
Cad Ref:	HD259 r7					Drawing No	HD06
						Revision	7
7	DA ISSUE			KU	23.06.22		
6	CLIENT DA ISSUE			KU	26.05.22		
5	CONCEPT INTERSECTION LAYOUT			KU	28.04.22		
No	Amendment			Drawn	Date		

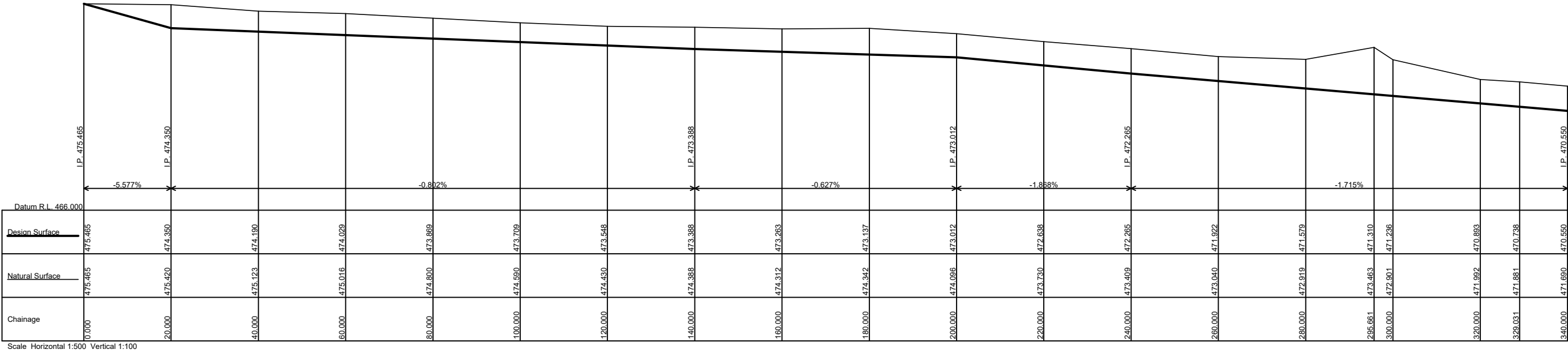
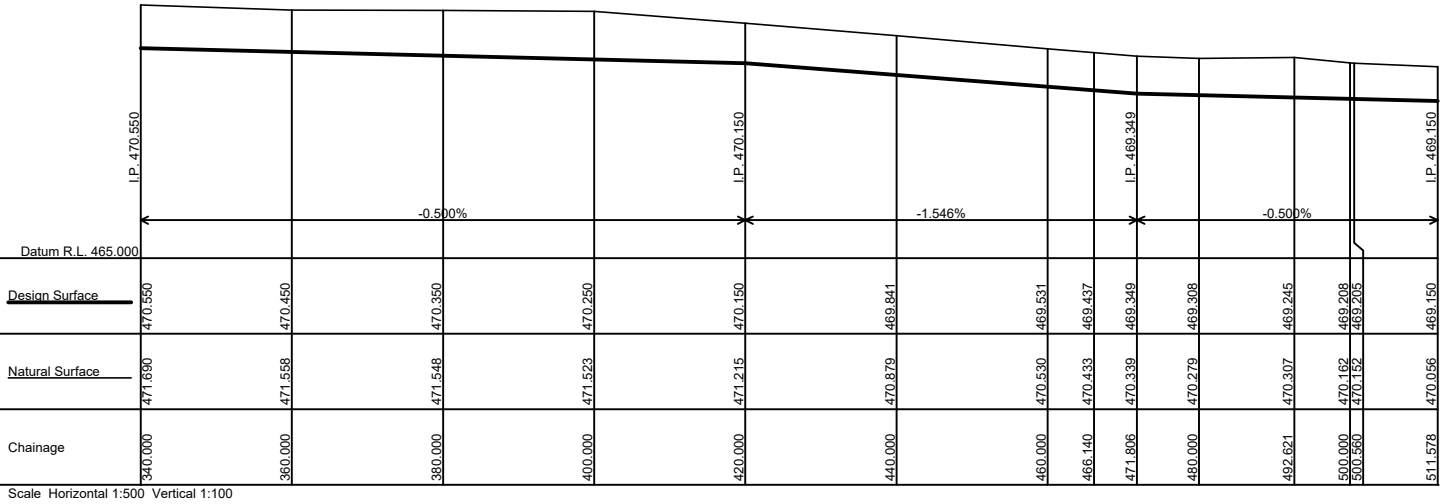

CHANNEL 01 LONGITUDINAL SECTION

TITLE: PROPOSED BUNNINGS DEVELOPMENT
CNR CASTLEREAGH HIGHWAY AND LIONS DRIVE
MUDGEE
CHANNEL LONGITUDINAL SECTION
CLIENT: BUNNINGS GROUP LIMITED



NOTE:
ALL EXISTING UNDERGROUND SERVICES MUST BE LOCATED AND EXPOSED PRIOR TO EARTHWORKS COMMENCING AND IT IS RESPONSIBILITY OF THOSE PERSONS USING THIS PLAN TO CONFIRM BOTH POSITION AND LEVEL OF THESE UTILITIES IN CONJUNCTION WITH THE APPROPRIATE AUTHORITY.

0 4 8 12 16 20 m
1:200

Date:	15.06.15	Scale:	1:600 A1	Designed:	KU
Cad Ref:	HD259 r7				
No	7	DA ISSUE		KU	23.06.22
	6	CLIENT DA ISSUE		KU	26.05.22
	5	CONCEPT INTERSECTION LAYOUT		KU	28.04.22
		Amendment		Drawn	Date

Project No	HD259
Drawing No	HD07
Revision	7

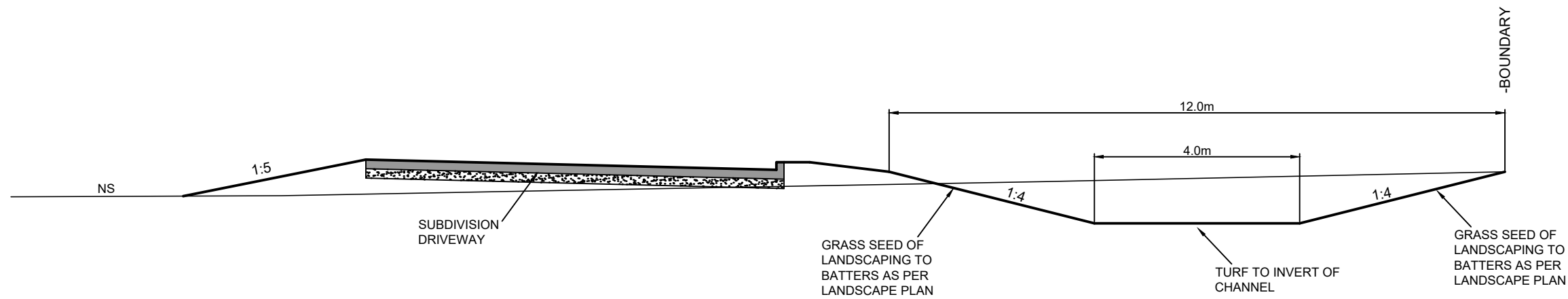

CHANNEL 1 TYPICAL SECTION (CHAINAGE 140)
Scale 1:50

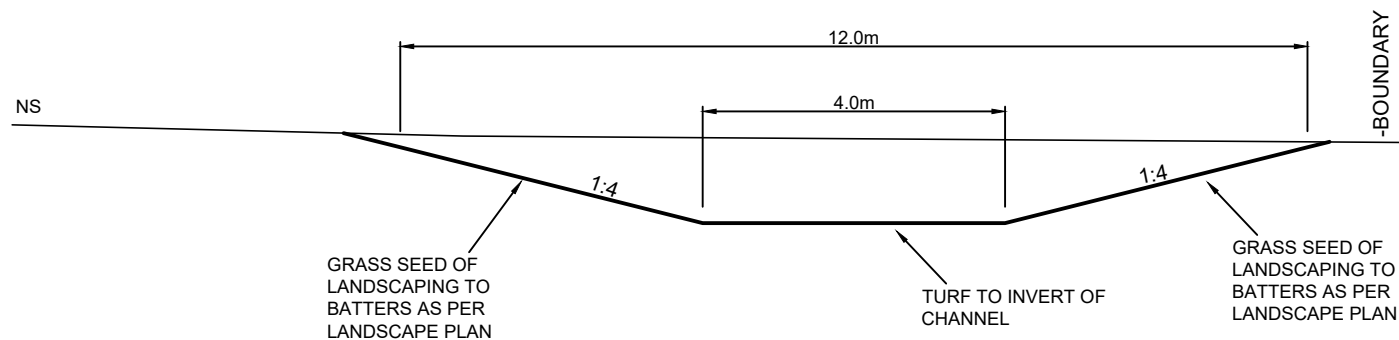

CHANNEL 1 TYPICAL SECTION (CHAINAGE 360)
Scale 1:50

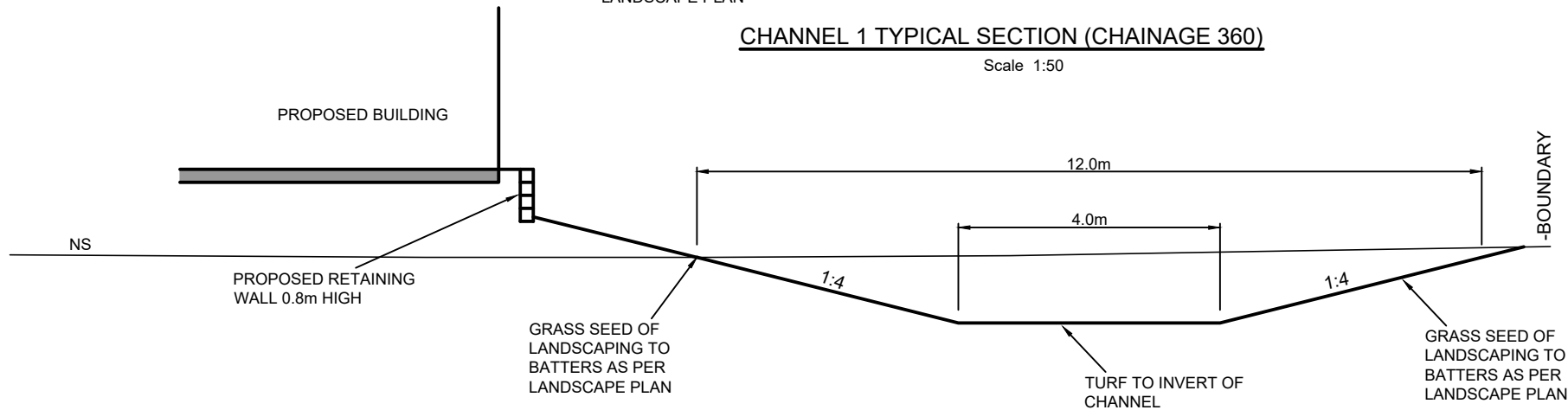

CHANNEL 1 TYPICAL SECTION (CHAINAGE 420.0)
Scale 1:50

TITLE: PROPOSED BUNNINGS DEVELOPMENT
CNR CASTLEREAGH HIGHWAY AND LIONS DRIVE
MUDGEE
CHANNEL TYPICAL CROSS SECTION
CLIENT: BUNNINGS GROUP LIMITED

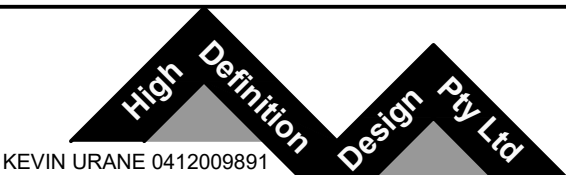

NOTE:
ALL EXISTING UNDERGROUND SERVICES MUST BE LOCATED AND EXPOSED PRIOR TO EARTHWORKS COMMENCING AND IT IS RESPONSIBILITY OF THOSE PERSONS USING THIS PLAN TO CONFIRM BOTH POSITION AND LEVEL OF THESE UTILITIES IN CONJUNCTION WITH THE APPROPRIATE AUTHORITY.

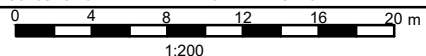

Date: 15.06.15		Scale: 1:600 A1		Designed: KU		Project No	
Cad Ref: HD259 r7						HD259	
7	DA ISSUE		KU	23.06.22		Drawing No	Revision
6	CLIENT DA ISSUE		KU	26.05.22			
5	CONCEPT INTERSECTION LAYOUT		KU	28.04.22			
No	Amendment		Drawn	Date		HD08	7



DRIVEWAY 1 LONGITUDINAL SECTION (SUBDIVISION ROAD)

Scale Horizontal 1:500 Vertical 1:100

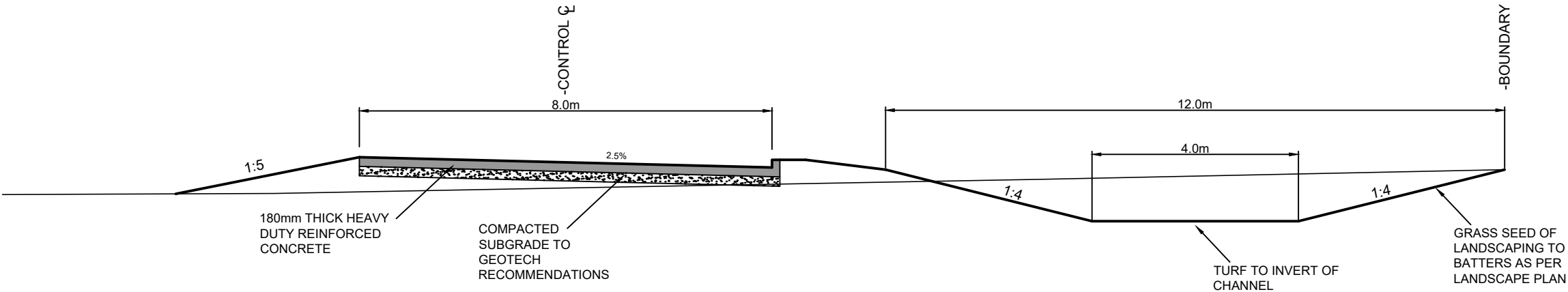

DRIVEWAY 1 TYPICAL SECTION (SUBDIVISION DRIVEWAY)

Scale 1:50

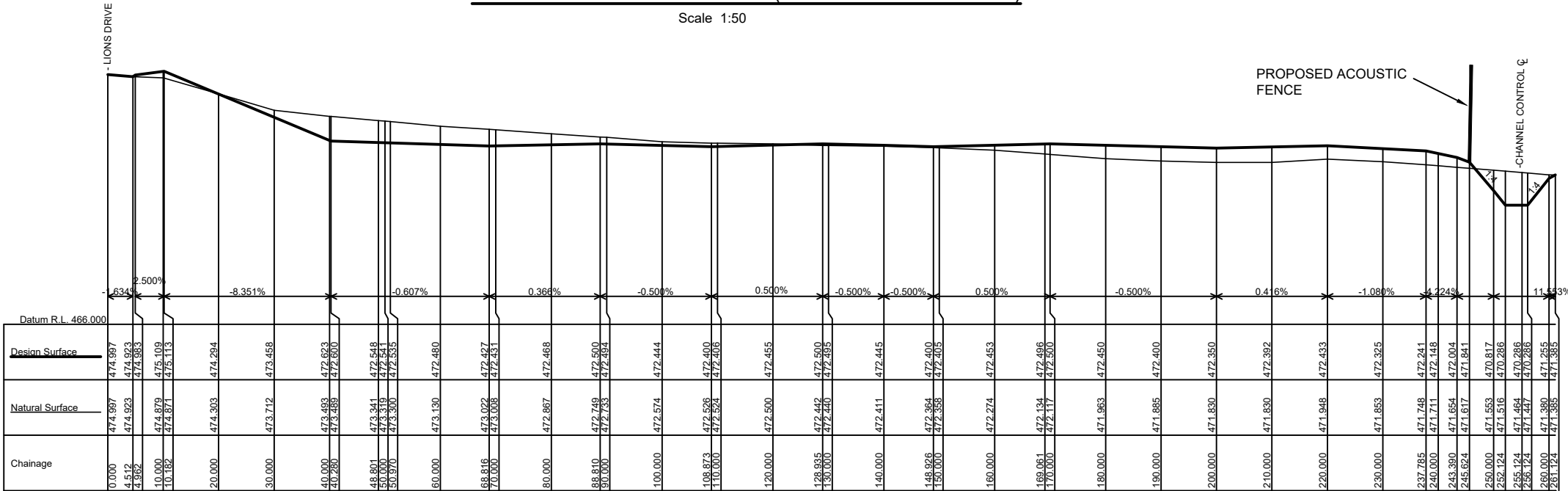

Scale Horizontal 1:500 Vertical 1:100

DRIVEWAY 2 LONGITUDINAL SECTION

Scale Horizontal 1:500 Vertical 1:100

TITLE: PROPOSED BUNNINGS DEVELOPMENT
CNR CASTLEREAGH HIGHWAY AND LIONS DRIVE
MUDGEE
DRIVEWAY LONGITUDINAL SECTIONS
CLIENT: BUNNINGS GROUP LIMITED



NOTE:
ALL EXISTING UNDERGROUND SERVICES MUST BE LOCATED AND EXPOSED PRIOR TO EARTHWORKS COMMENCING AND IT IS RESPONSIBILITY OF THOSE PERSONS USING THIS PLAN TO CONFIRM BOTH POSITION AND LEVEL OF THESE UTILITIES IN CONJUNCTION WITH THE APPROPRIATE AUTHORITY.

0 4 8 12 16 20 m
1:200

Date:	15.06.15	Scale:	1:600 A1	Designed:	KU	Project No	HD259
Cad Ref:	HD259 r7					Drawing No	HD08
7	DA ISSUE			KU	23.06.22	Revision	7
6	CLIENT DA ISSUE			KU	26.05.22		
5	CONCEPT INTERSECTION LAYOUT			KU	28.04.22		
No	Amendment			Drawn	Date		

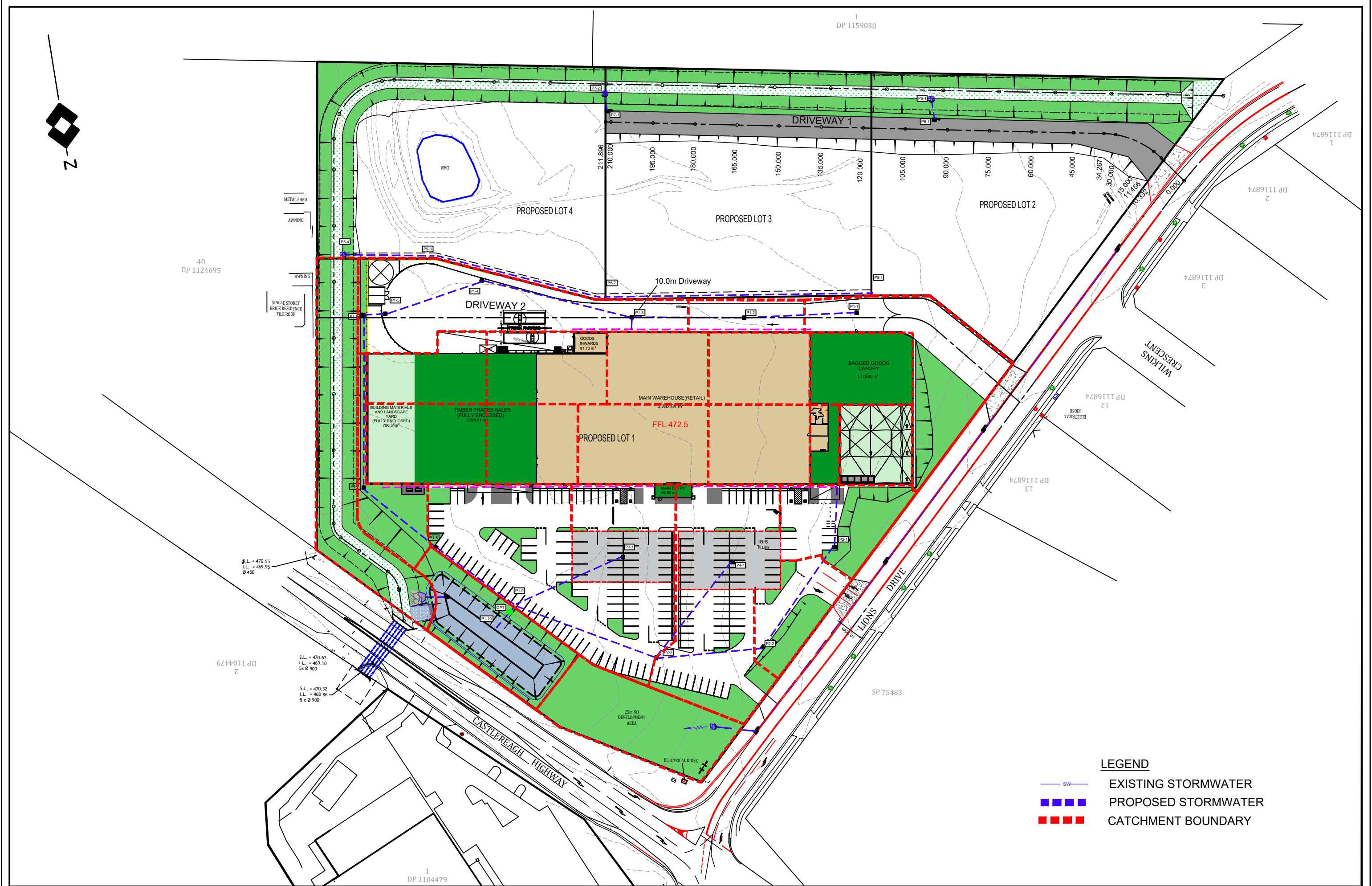

LEGEND

- EXISTING STORMWATER
- PROPOSED STORMWATER
- CATCHMENT BOUNDARY

TITLE: PROPOSED BUNNINGS DEVELOPMENT
CNR CASTLEREAGH HIGHWAY AND LIONS DRIVE
MUDGEE LOT 2 DP1079362
CATCHMENT PLAN
CLIENT: BUNNINGS GROUP LIMITED



High Definition Design Pty Ltd
KEVIN URANE 0412009891

NOTE:
ALL EXISTING UNDERGROUND SERVICES MUST BE LOCATED AND EXPOSED PRIOR TO EARTHWORKS COMMENCING AND IT IS RESPONSIBILITY OF THOSE PERSONS USING THIS PLAN TO CONFIRM BOTH POSITION AND LEVEL OF THESE UTILITIES IN CONJUNCTION WITH THE APPROPRIATE AUTHORITY.

Date:	15.06.15	Scale:	1:600 A1	Designed:	KU	Project No:	HD259
Cad Ref:	HD259 r7					Drawing No:	HD10
7	DA ISSUE			KU	23.06.22	Revision:	7
6	CLIENT DA ISSUE			KU	26.05.22		
5	CONCEPT INTERSECTION LAYOUT			KU	28.04.22		
No	Amendment			Drawn	Date		

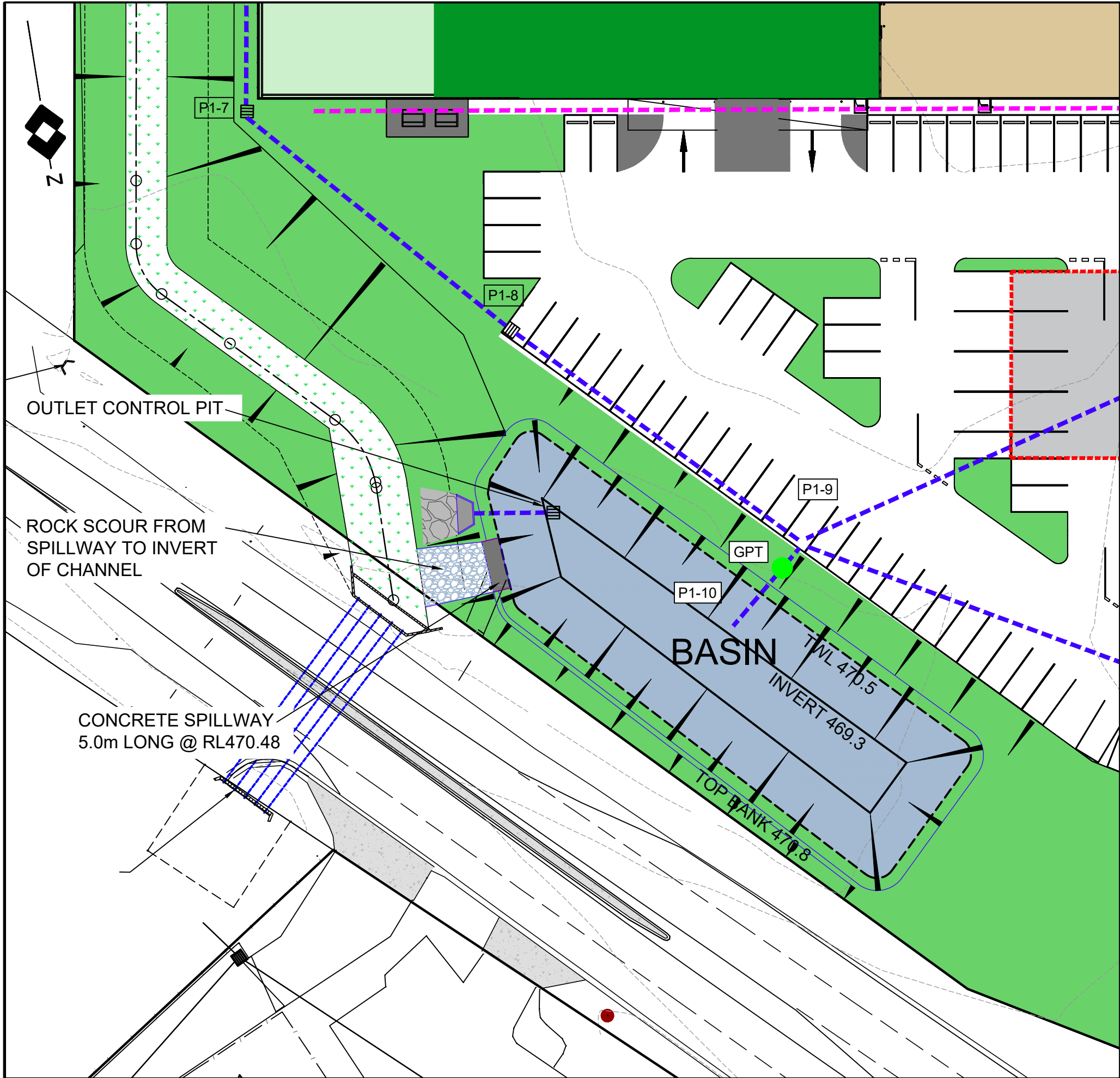

LEGEND

- 10.00
- DESIGN CONTOURS (0.25m INTERVALS)
- PROPOSED STORMWATER PIPE
- PIT
- PROPOSED ROCK SCOUR

PIT SCHEDULE

PIT NUMBER	SURFACE LEVEL	INVERT LEVEL	PIT SIZE
P1-1	472.4	471.8	900X900
P1-2	472.4	471.8	900X900
P1-3	472.4	471.2	900X900
P1-4	422.3	470.8	900X900
P1-5	472.1	470.5	1200X1200
P1-6	471.9	470.4	900X900
P1-7	472.3	469.9	1200X1200
P1-8	472.1	469.6	1200X1200
P1-9	471.8	469.4	1200X1200
P1-10		469.3	HEADWALL
P2-1	472.35	471.5	900X900
P2-2	472.3	471.1	900X900
P2-3	471.6	470.7	900X900
P3-1	472.05	470.7	900X900
P4-1	472.1	471.1	900X900
P5-1	472.4	470.6	900X900
P5-2	472.6	470.9	1200X1200
P5-3	472.4	470.6	1200X1200
P5-4		470.4	HEADWALL
P6-1	13.6	12.600	
P6-2		12.402	HEADWALL
P7-1	13.6	12.600	
P7-2		12.402	HEADWALL

BASIN OUTLET DETAILS

OUTLET PIT SIZE 1200x 1200 LEVEL TOP PIT 470.35
LOW LEVEL ORIFICE RL 369.3 SIZE: 160mm
HIGH LEVEL ORIFICE RL470.19 SIZE : 200mm x 1200mm
SPILLWAY LEVEL RL470.48 5.0m WIDE

TITLE: PROPOSED ROAD WORKS
CNR CASTLEREAGH HIGHWAY AND LIONS DRIVE
MUDGEE
AERIAL OVERLAY
CLIENT: BUNNINGS GROUP LIMITED



NOTE:
ALL EXISTING UNDERGROUND SERVICES MUST BE LOCATED AND EXPOSED PRIOR TO EARTHWORKS COMMENCING AND IT IS RESPONSIBILITY OF THOSE PERSONS USING THIS PLAN TO CONFIRM BOTH POSITION AND LEVEL OF THESE UTILITIES IN CONJUNCTION WITH THE APPROPRIATE AUTHORITY.

Date:	15.06.15	Scale:	1:200 A1	Designed:	KU
Cad Ref:	HD259 r7				
No	7	DA ISSUE		KU	23.06.22
No	6	CLIENT DA ISSUE		KU	26.05.22
No	5	CONCEPT INTERSECTION LAYOUT		KU	28.04.22
No		Amendment		Drawn	Date

Project No
HD259
Drawing No
HD11
Revision
7

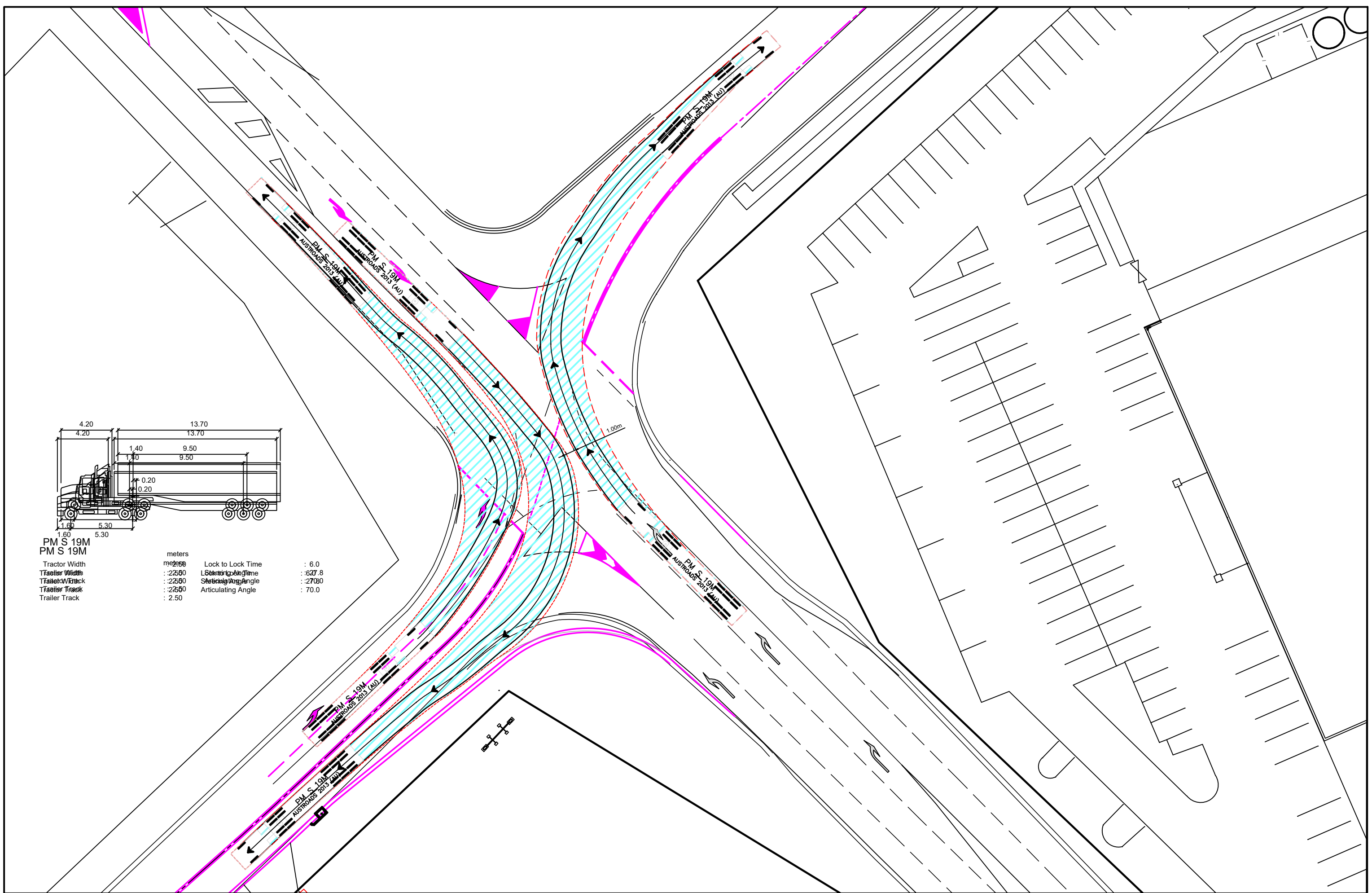

PM S 19M	Tractor Width	4.20	Lock to Lock Time	: 6.0	
PM S 19M	Trailer Width	13.70	Lock to Lock Time	: 6.0	
Tractor Width	: 4.20	Tractor Height	: 1.40	Tractor Articulating Angle	: 0.20
Trailer Width	: 13.70	Trailer Height	: 9.50	Trailer Articulating Angle	: 0.20
Tractor Track	: 1.60	Tractor Height	: 1.40	Tractor Articulating Angle	: 0.20
Trailer Track	: 5.30	Trailer Height	: 9.50	Trailer Articulating Angle	: 0.20

TITLE: PROPOSED ROAD WORKS
CNR CASTLEREAGH HIGHWAY AND LIONS DRIVE
MUDGEE
TURNING MOVEMENT 1 OF 3
CLIENT: BUNNINGS GROUP LIMITED



High Definition Design Pty Ltd
KEVIN URANE 0412009891

NOTE:
ALL EXISTING UNDERGROUND SERVICES MUST BE LOCATED AND EXPOSED PRIOR TO EARTHWORKS COMMENCING AND IT IS RESPONSIBILITY OF THOSE PERSONS USING THIS PLAN TO CONFIRM BOTH POSITION AND LEVEL OF THESE UTILITIES IN CONJUNCTION WITH THE APPROPRIATE AUTHORITY.

Date:	15.06.15	Scale:	1:200 A1	Designed:	KU	Project No:	HD259
Cad Ref:	HD259 r7					Drawing No:	HD12
	7	DA ISSUE		KU	23.06.22	Revision:	7
	6	CLIENT DA ISSUE		KU	26.05.22		
	5	CONCEPT INTERSECTION LAYOUT		KU	28.04.22		
No		Amendment		Drawn	Date		

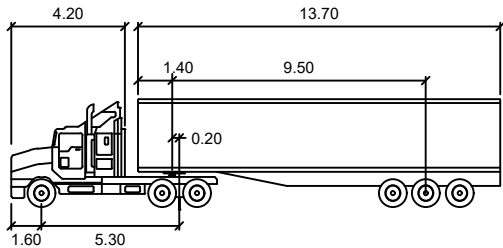
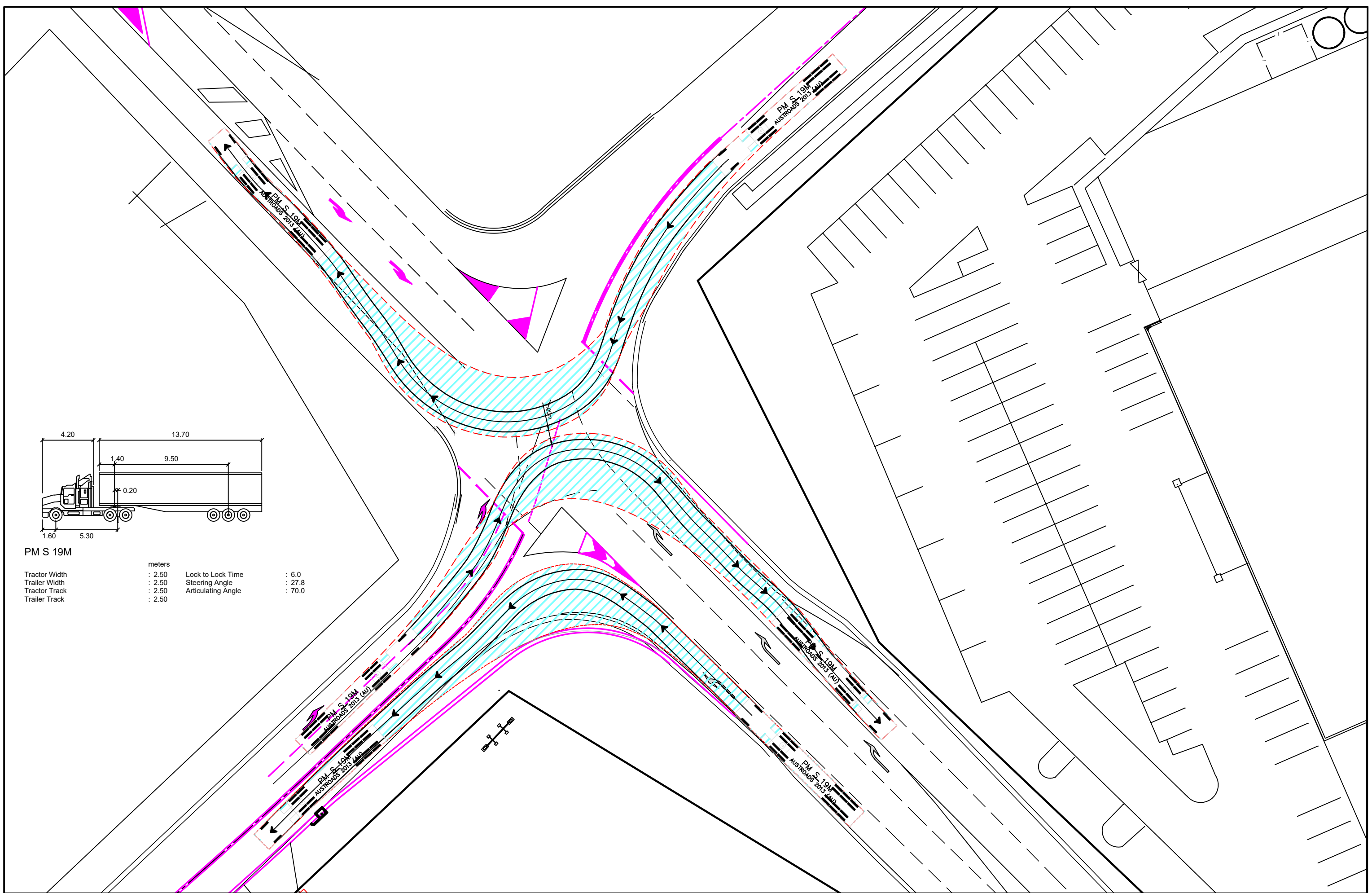

PM S 19M

	metres		
Tractor Width	: 2.50	Lock to Lock Time	: 6.0
Trailer Width	: 2.50	Steering Angle	: 27.8
Tractor Track	: 2.50	Articulating Angle	: 70.0
Trailer Track	: 2.50		

TITLE: PROPOSED ROAD WORKS
CNR CASTLEREAGH HIGHWAY AND LIONS DRIVE
MUDGEE
TURNING MOVEMENT 2 OF 3
CLIENT: BUNNINGS GROUP LIMITED

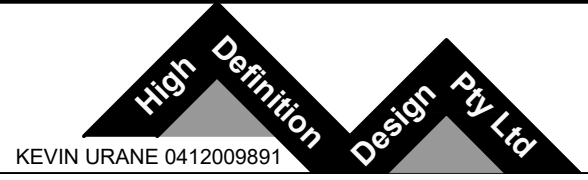

NOTE:
ALL EXISTING UNDERGROUND SERVICES MUST BE LOCATED AND EXPOSED PRIOR TO EARTHWORKS COMMENCING AND IT IS RESPONSIBILITY OF THOSE PERSONS USING THIS PLAN TO CONFIRM BOTH POSITION AND LEVEL OF THESE UTILITIES IN CONJUNCTION WITH THE APPROPRIATE AUTHORITY.

Date: 15.06.15		Scale: 1:200 A1		Designed: KU		Project No	
Cad Ref: HD259 r7						HD259	
7	DA ISSUE		KU	23.06.22		Drawing No	Revision
6	CLIENT DA ISSUE		KU	26.05.22			
5	CONCEPT INTERSECTION LAYOUT		KU	28.04.22		HD13	7
No	Amendment		Drawn	Date			

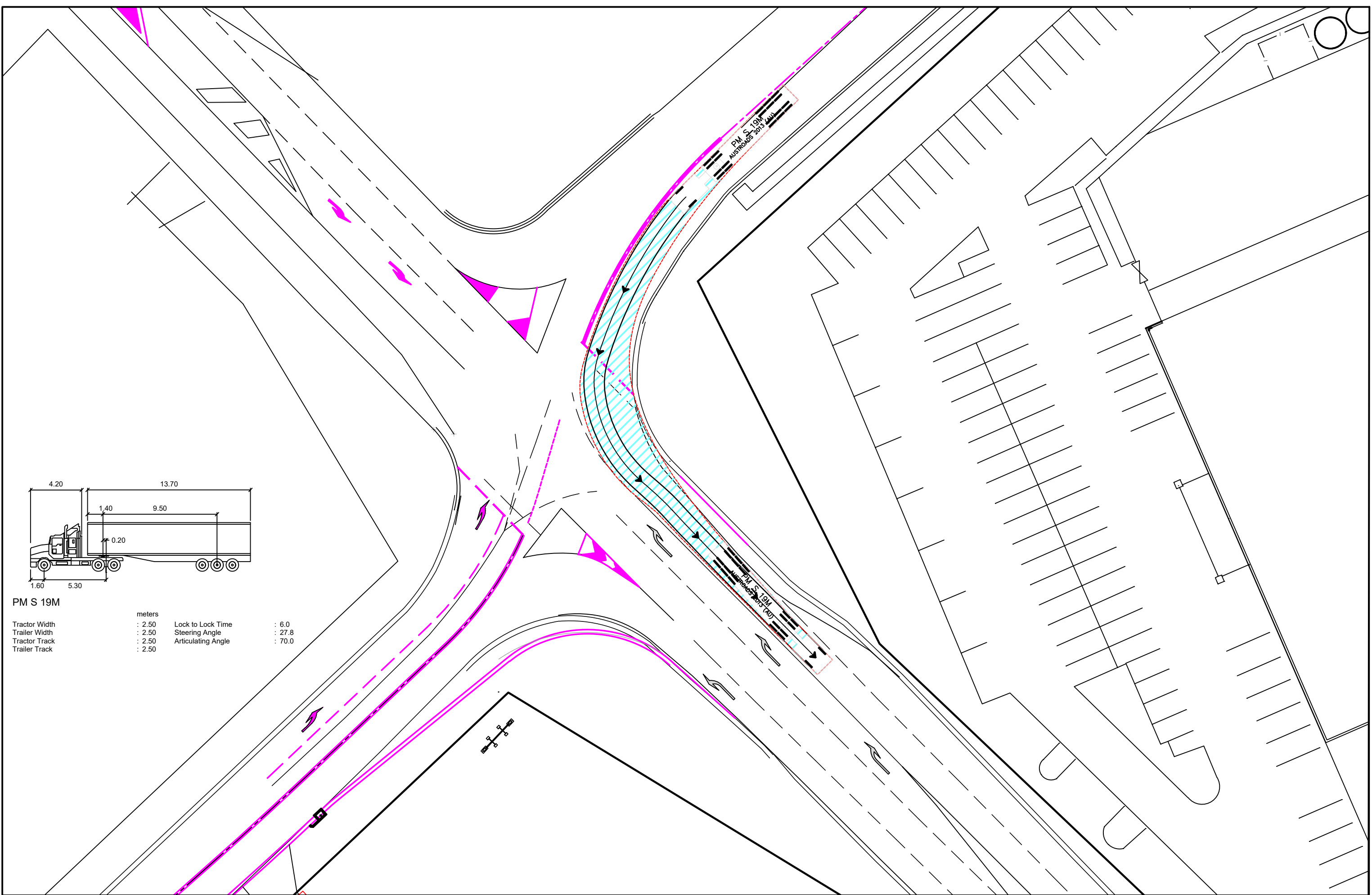

TITLE: PROPOSED ROAD WORKS
CNR CASTLEREAGH HIGHWAY AND LIONS DRIVE
MUDGEE
TURNING MOVEMENT 3 OF 3
CLIENT: BUNNINGS GROUP LIMITED

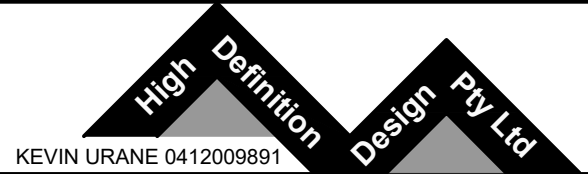

NOTE:
ALL EXISTING UNDERGROUND SERVICES MUST BE LOCATED AND EXPOSED PRIOR TO EARTHWORKS COMMENCING AND IT IS RESPONSIBILITY OF THOSE PERSONS USING THIS PLAN TO CONFIRM BOTH POSITION AND LEVEL OF THESE UTILITIES IN CONJUNCTION WITH THE APPROPRIATE AUTHORITY.

0 4 8 12 16 20 m
1:200

Date:	15.06.15	Scale:	1:200 A1	Designed:	KU	Project No:	HD259
Cad Ref:	HD259 r7					Drawing No:	HD14
7	DA ISSUE			KU	23.06.22	Revision:	7
6	CLIENT DA ISSUE			KU	26.05.22		
5	CONCEPT INTERSECTION LAYOUT			KU	28.04.22		
No	Amendment			Drawn	Date		



www.dialbeforeyoudig.com.au

DIAL1100
BEFORE YOU DIG

TITLE: PROPOSED BUNNINGS DEVELOPMENT
CNR CASTLEREAGH HIGHWAY AND LIONS DRIVE
MUDGEE

EROSION AND SEDIMENT CONTROL PLAN

CLIENT: BUNNINGS GROUP LIMITED



High Definition Design Pty Ltd

KEVIN URANE 0412009891

NOTE:
ALL EXISTING UNDERGROUND SERVICES MUST BE LOCATED AND EXPOSED PRIOR TO EARTHWORKS COMMENCING AND IT IS RESPONSIBILITY OF THOSE PERSONS USING THIS PLAN TO CONFIRM BOTH POSITION AND LEVEL OF THESE UTILITIES IN CONJUNCTION WITH THE APPROPRIATE AUTHORITY.

0 4 8 12 16 20 m

1:200

Date:	15.06.15	Scale:	1:600 A1	Designed:	KU	Project No:	HD259
Cad Ref:	HD259 r7					Drawing No:	HD15
7	DA ISSUE			KU	23.06.22	Revision:	7
6	CLIENT DA ISSUE			KU	26.05.22		
5	CONCEPT INTERSECTION LAYOUT			KU	28.04.22		
No	Amendment			Drawn	Date		

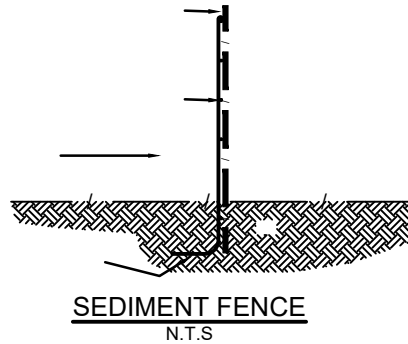
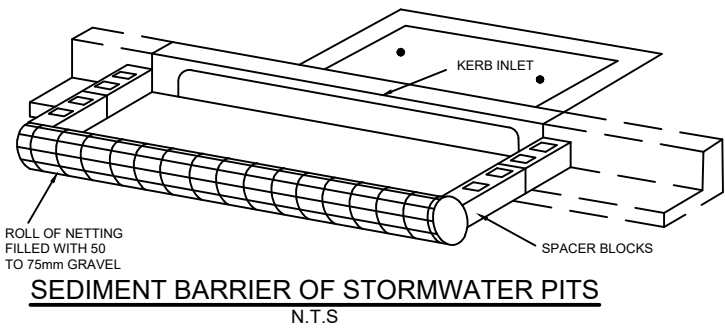
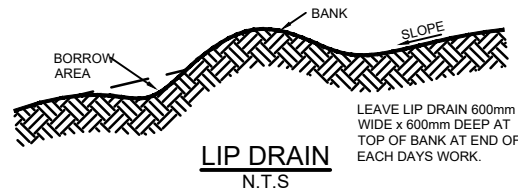

EROSION CONTROL

1. EROSION CONTROL DEVICES AND SILTATION TRAPS TO BE INSTALLED BEFORE SITE IS DISTURBED IN ACCORDANCE WITH N.S.W. DEPARTMENT OF CONSERVATION AND LAND MANAGEMENT GUIDELINES AND APPROVED BY COUNCIL INSPECTOR.
2. ALL PERIMETER AND CONTROL MEASURES ARE TO BE PLACED PRIOR TO OR AS THE FIRST STEP IN EARTHWORKS AND/OR CLEARING.
3. SILT TO BE REMOVED FROM TEMPORARY SEDIMENT CONTROL BASINS AS DIRECTED BY COUNCIL INSPECTOR OR DEPARTMENT OF LAND AND WATER CONSERVATION REPRESENTATIVE TO MAINTAIN SILTATION STORAGE CAPACITY IN TEMPORARY BASINS.
4. FILTRATION BUFFER ZONES ARE TO BE FENCED OFF AND ACCESS PROHIBITED TO ALL PLANT AND MACHINERY.
5. HAY BALE BARRIERS AND GEOFABRIC FENCES ARE TO BE CONSTRUCTED TO TOE OF BATTER PRIOR TO COMMENCEMENT OF EARTHWORKS IMMEDIATELY AFTER CLEARING OF VEGETATION BEFORE REMOVAL OF TOPSOIL.
6. SANDBAGS TO BE USED DURING ROAD CONSTRUCTION TO DIVERT STORMWATER INTO PITS WHEN SUBGRADE IS UP TO KERB LEVEL.
7. ALL TEMPORARY EARTH BERMS, DIVERSION AND SILT DAM EMBANKMENTS ARE TO BE MACHINE COMPACTED, SEEDED & MULCHED FOR TEMPORARY VEGETATION COVER AS SOON AS THEY HAVE BEEN FORMED.
8. CLEAN WATER IS TO BE DIVERTED AWAY FROM DISTURBED GROUND AND INTO DRAINAGE SYSTEM.
9. ALL SEDIMENT TRAPPING STRUCTURES AND DEVICES ARE TO BE INSPECTED AFTER STORMS FOR STRUCTURAL DAMAGE OR CLOGGING. TRAPPED MATERIAL IS TO BE REMOVED TO A SAFE APPROVED LOCATION.
10. ALL TOPSOIL IS TO BE STOCKPILED ON SITE FOR RE-USE (AWAY FROM TREES AND DRAINAGE LINES). MEASURES SHALL BE APPLIED TO PREVENT EROSION OF THE STOCKPILES.
11. ALL FILLS ARE TO BE LEFT WITH A LIP AT THE TOP OF THE SLOPE AT THE END OF EACH DAYS EARTHWORKS. THE HEIGHT OF THE LIP SHALL BE A MINIMUM OF 200mm.
12. ALL CUT AND FILL SLOPES ARE TO BE SEEDED AND MULCHED WITHIN 10 DAYS OF COMPLETION OF FORMATION.
13. UNDERSCRUBBING OF VEGETATION TO BE RESTRICTED TO SLASHING TO MINIMISE SOIL DISTURBANCE.
14. UPON COMPLETION OF ALL EARTHWORKS OR AS DIRECTED BY COUNCIL, SOIL CONSERVATION TREATMENTS SHALL BE APPLIED TO RENDER AREAS THAT HAVE BEEN DISTURBED, EROSION PROOF WITHIN 14 DAYS.
15. DENUDED AREAS TO BE STRIP TURFED OR HYDROMULCH SEEDED WITH THE SEED MIX BELOW OR APPROVED BY DEPARTMENT OF LAND AND WATER CONSERVATION REPRESENTATIVE, WITHIN 14 DAYS OF PRACTICAL COMPLETION OF EARTHWORKS. STRIPS ARE TO BE PLACED ACROSS THE CONTOUR AT RIGHT ANGLES TO THE DIRECTION OF SLOPE.

HYDROMULCH SEEDMIXES

SUMMER MIX		AUTUMN MIX	
MATERIAL	APPLICATION RATE	MATERIAL	APPLICATION RATE
JAPANESE MILLET	30 Kg/Ha	OATS	20 Kg/Ha
COUCH	10 Kg/Ha	RYE GRASS	10 Kg/Ha
CARPET GRASS	10 Kg/Ha	RED CLOVER	5 Kg/Ha
HAIFA WHITE CLOVER	5 Kg/Ha	WHITE CLOVER	5 Kg/Ha
BINDER	200 l/Ha	COUCH	10 Kg/Ha
PULP	1000 Kg/Ha	FERTILISER ENRICHER	300 Kg/Ha
FERTILISER	300 Kg/Ha	OR	
		DYNAMIC LIFTER	1000Kg/Ha

16. THE AREA OVER ALL STORMWATER AND SEWER LINES NOT WITHIN ROAD RESERVES IS TO BE MULCHED AND SEEDED WITHIN 14 DAYS AFTER BACKFILL.
17. NO MORE THAN 150m OF TRENCH IS TO BE OPEN AT ANY ONE TIME.
18. AREAS OVER ELECTRICITY, TELEPHONE AND GAS SUPPLY TRENCHES ARE TO BE SEEDED AND MULCHED BY THE RELEVANT AUTHORITY WITHIN 14 DAYS AFTER BACKFILL.
19. ALL FOOTPATHS, BERMS AND BATTERS AND SITE REGRADING AREAS ARE TO BE TOPSOILED WITH MINIMUM 75mm OF SELECTED SITE TOPSOIL AND GRASSED.
20. STRIPS OF TURF ARE TO BE PLACED IMMEDIATELY BEHIND THE KERB AND GUTTER ON ALL NEW ROADS AND AT LOCATIONS AS DETERMINED BY COUNCIL'S SUPERVISING OFFICER.
21. ALL FINAL EROSION PREVENTION MEASURES INCLUDING THE ESTABLISHMENT OF GRASSING ARE TO BE COMPLETED PRIOR TO THE SUBDIVISION FINAL INSPECTION. ALL EROSION DEVICES ARE TO BE MAINTAINED UNTIL THE END OF THE MAINTENANCE PERIOD.

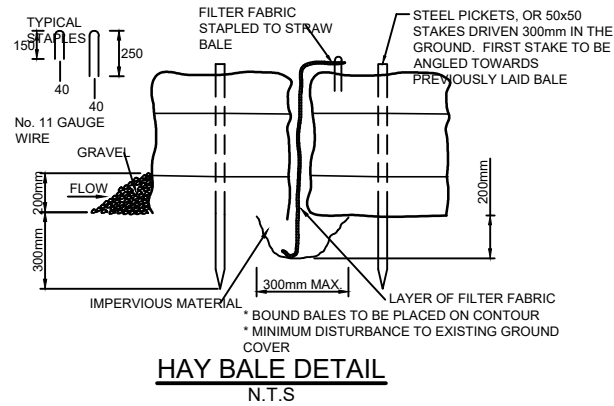

TITLE: PROPOSED BUNNINGS DEVELOPMENT
CNR CASTLEREAGH HIGHWAY AND LIONS DRIVE
MUDGEE

SEDIMENT AND EROSION CONTROL DETAILS

CLIENT: BUNNINGS GROUP LIMITED



KEVIN URANE 0412009891

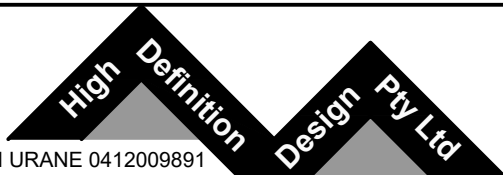

NOTE:

ALL EXISTING UNDERGROUND SERVICES MUST BE LOCATED AND EXPOSED PRIOR TO EARTHWORKS COMMENCING AND IT IS RESPONSIBILITY OF THOSE PERSONS USING THIS PLAN TO CONFIRM BOTH POSITION AND LEVEL OF THESE UTILITIES IN CONJUNCTION WITH THE APPROPRIATE AUTHORITY.

Date: 15.06.15 Scale: 1:600 A1 Designed: KU

Cad Ref: HD259 r7

7	DA ISSUE	KU	23.06.22
6	CLIENT DA ISSUE	KU	26.05.22
5	CONCEPT INTERSECTION LAYOUT	KU	28.04.22
No	Amendment	Drawn	Date

Project No

HD259

Drawing No

HD16

Revision

7

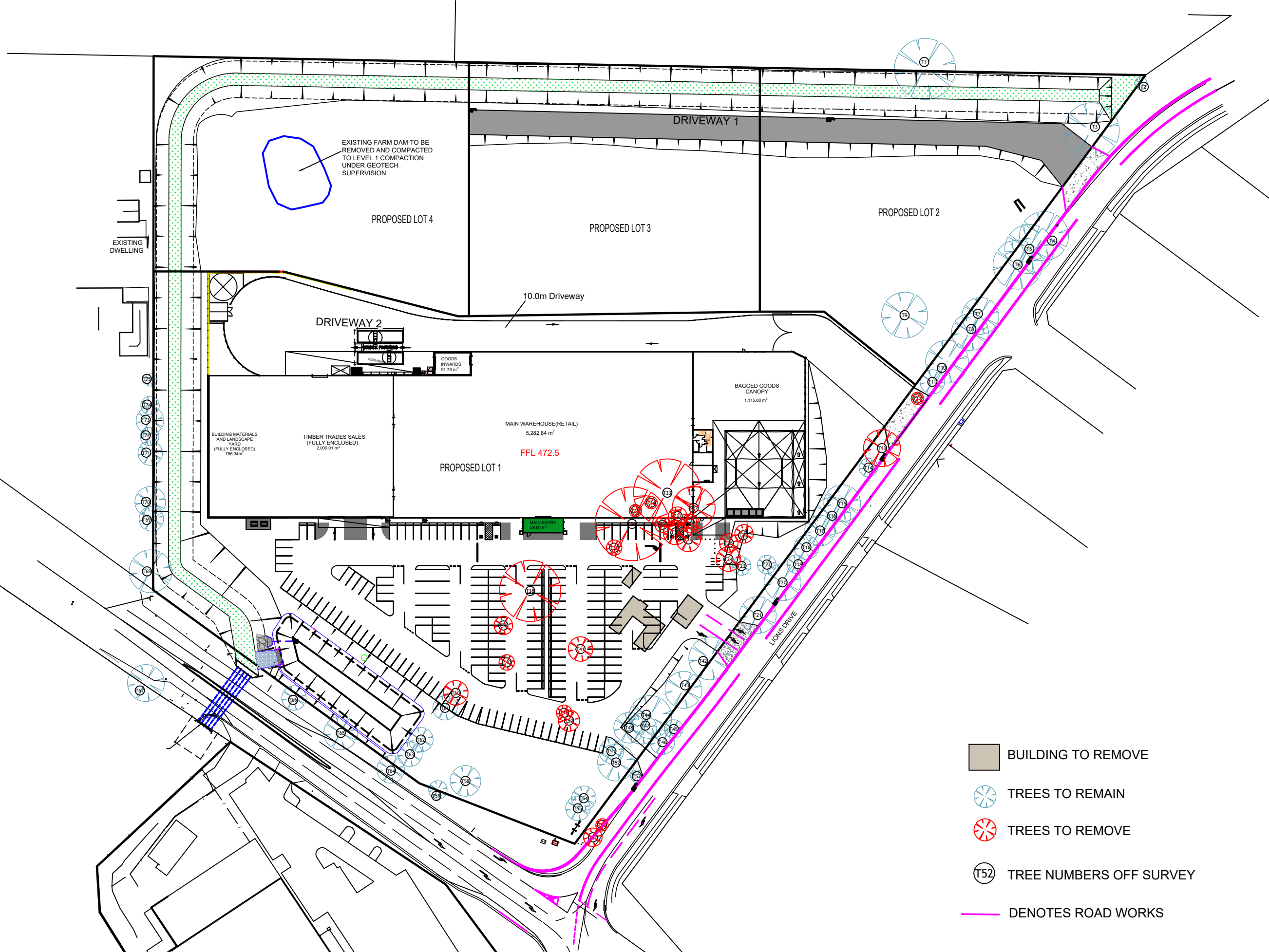

- BUILDING TO REMOVE
- TREES TO REMAIN
- TREES TO REMOVE
- TREE NUMBERS OFF SURVEY
- DENOTES ROAD WORKS

www.dialbeforeyoudig.com.au



TITLE: PROPOSED BUNNINGS DEVELOPMENT
CNR CASTLEREAGH HIGHWAY AND LIONS DRIVE
MUDGEE
TREE REMOVAL AND DEMOLITION PLAN
CLIENT: BUNNINGS GROUP LIMITED

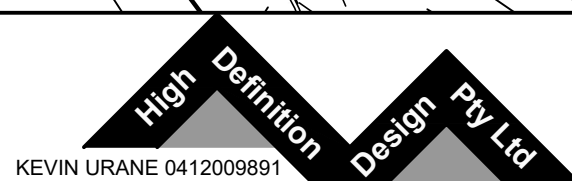

KEVIN URANE 0412009891

NOTE:
ALL EXISTING UNDERGROUND SERVICES MUST BE LOCATED AND EXPOSED PRIOR TO EARTHWORKS COMMENCING AND IT IS RESPONSIBILITY OF THOSE PERSONS USING THIS PLAN TO CONFIRM BOTH POSITION AND LEVEL OF THESE UTILITIES IN CONJUNCTION WITH THE APPROPRIATE AUTHORITY.

0 4 8 12 16 20 m
1:200

Date:	15.06.15	Scale:	1:600 A1	Designed:	KU	Project No	HD259	
Cad Ref:	HD259 r7					Drawing No	HD17	Revision
7	DA ISSUE			KU	23.06.22			
6	CLIENT DA ISSUE			KU	26.05.22			
5	CONCEPT INTERSECTION LAYOUT			KU	28.04.22			
No	Amendment			Drawn	Date			