

SKETCH SHOWING PROPOSED SUBDIVISION OF LOT 20 DP 1273049

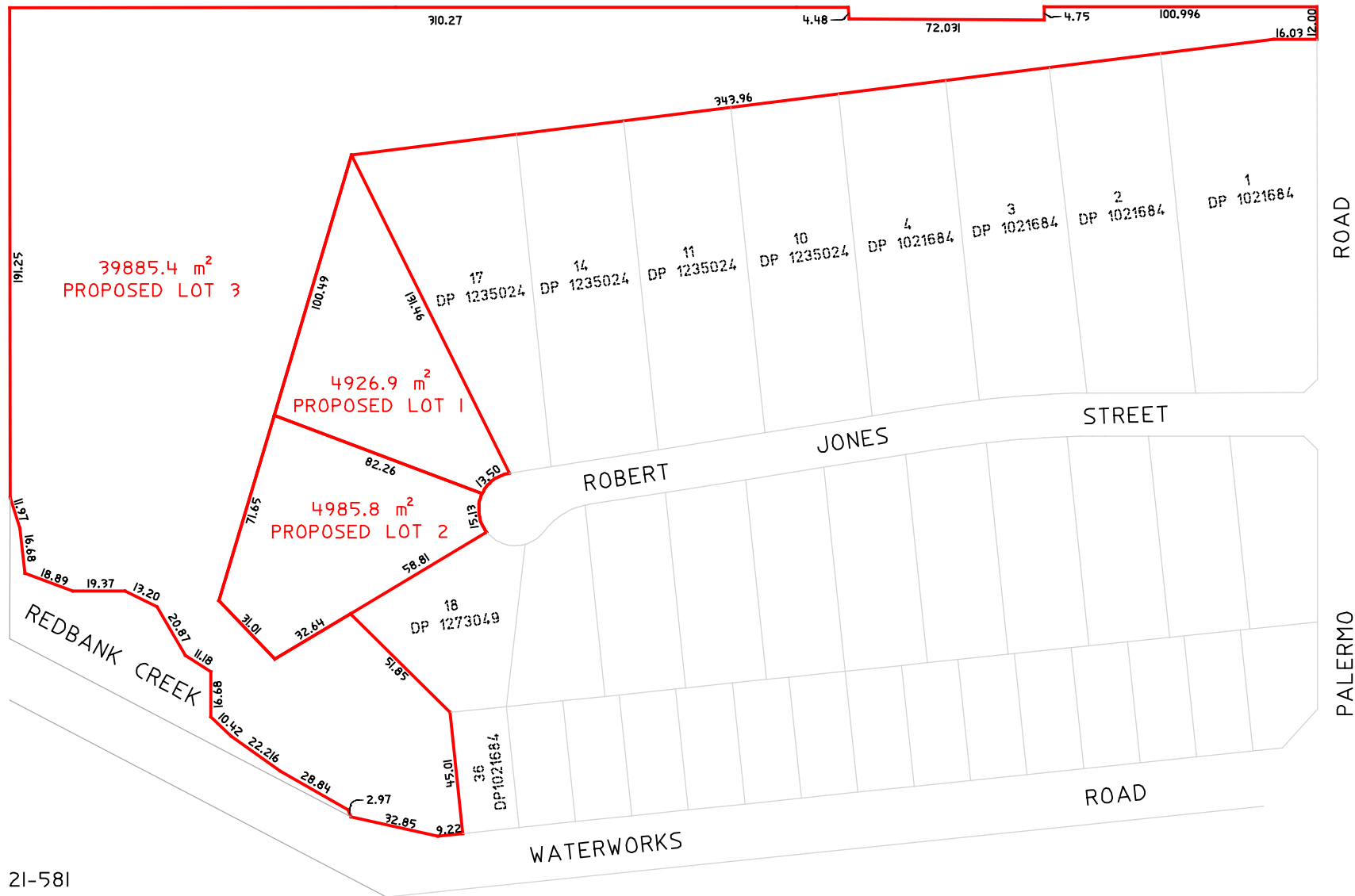

REFERENCE: 21-581
 DATE: 15 / 08 / 2021
 NOT TO SCALE. USE STATED DIMENSIONS
 L.G.A: MID WESTERN REGIONAL
 LOCALITY: MUDGEE

This document was created by an application that isn't licensed to use [novaPDF](#).
 Purchase a license to generate PDF files without this notice.