



On Point
BUILDING DESIGN

CONTACT DETAILS

Gabrielle Hackett
M. 0437 762 740
E. gabrielle@onpointbuildingdesign.com.au
A. 17 Church Street, Mudgee NSW 2850

THIS DRAWING IS AND ALWAYS SHALL REMAIN THE PROPERTY OF ON POINT BUILDING DESIGN AND MUST NOT BE LENT, GIVEN, SOLD, REPRODUCED OR VARIED IN ANY WAY WITHOUT WRITTEN CONSENT.
ALL DIMENSIONS ARE IN MILLIMETRES. DO NOT SCALE. DIMENSIONS TO BE CHECKED ON SITE BEFORE COMMENCEMENT OF WORK.

Client:
BRIAN & SYLVIA SCATTERGOOD
Project:
**PROPOSED RESIDENCE AT
19 HUGHSON AVENUE,
MUDGEE**

Drawing Title:
SITE LAYOUT

Rev	Date	Amendment
A	21/09/21	PRELIMINARY DRAWINGS
B	22/09/21	PRELIMINARY DRAWINGS
C	24/09/21	PRELIMINARY DRAWINGS
D	1/10/21	PRELIMINARY DRAWINGS
E	12/10/21	PRELIMINARY DRAWINGS



Job Number: 1247 - A02
Revision: E
Sheet 02 of 10

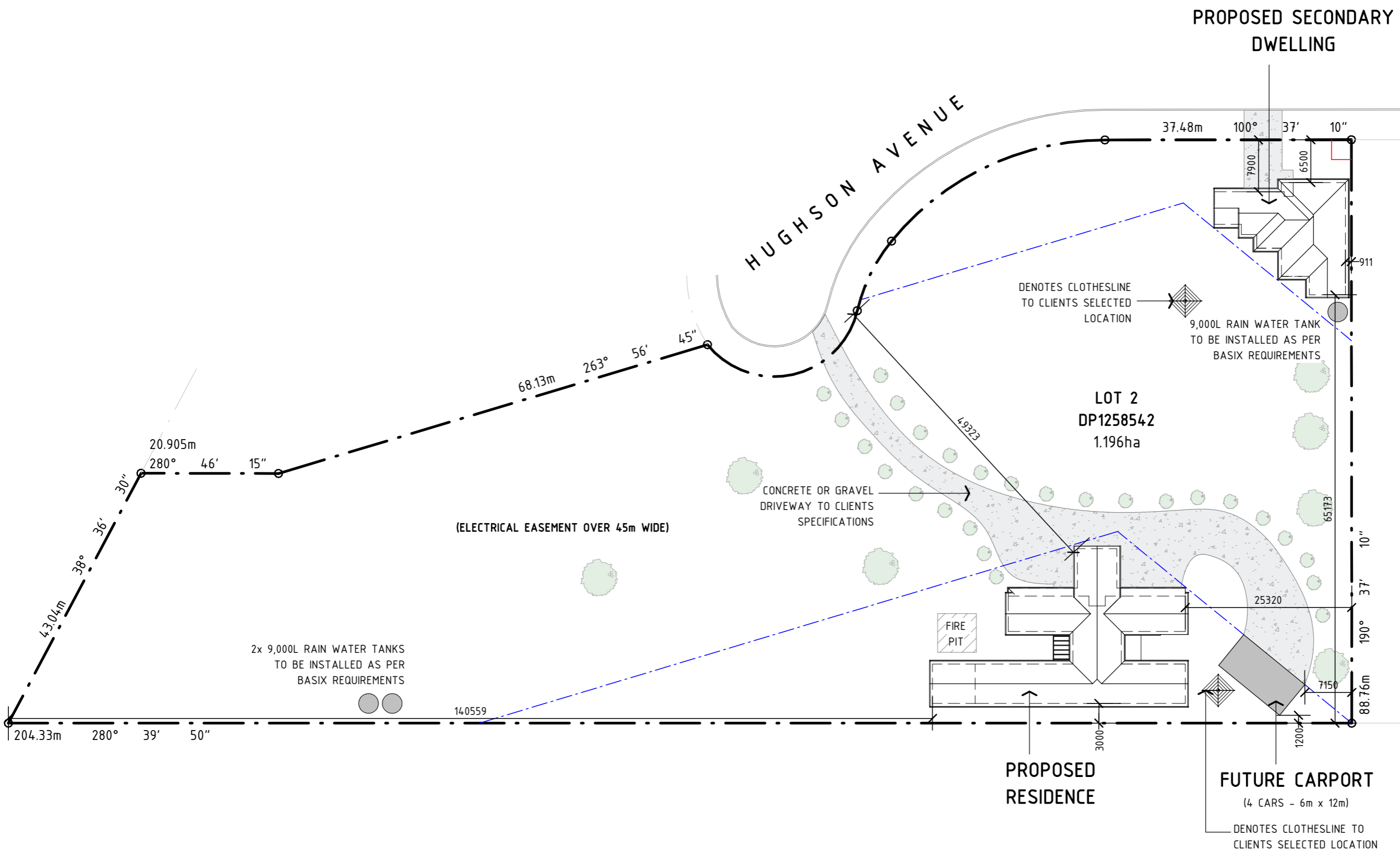

02 | SITE LAYOUT
SCALE: 1 : 600 (A3)

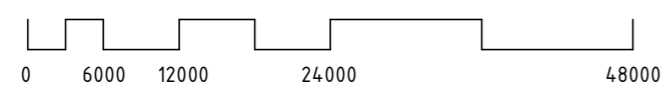

PRELIMINARY DRAWINGS